

# HA-VIIGT Color Screen Alarm Panel

## User manual

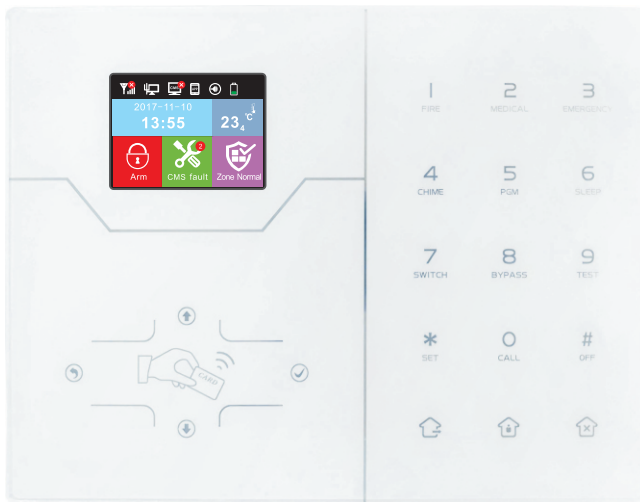

4G Network

P/N:22280304B03



## Brief

Thank you for purchasing the “smart home” products of our company, we hope our products can bring convenience and protection for your safety! The “smart home” system uses the most advanced digital sensing and control technology, it is a set of smart alarm control system of anti-theft, anti-fire, and anti-gas leak compatible with wired and wireless alarm. 4G network makes alarm information transmission more smoothly. This product does not need to memorize tedious commands. It is easy to operate, easy to learn and use.

The “smart home” system recommends the most advanced multi-random vault technology in safety and reliability, which effectively solve the problem of interference, false positives, false negatives that cannot be solved by similar system at present .The way the “smart home” system uses in the alarm signal on the common high-speed way CONTACT ID makes application of this series of products wider and compatibility stronger. The system can be widely used in family ,community,villas,shops,units and so on.

We recommend that you carefully read the instruction to facilitate you for a skilled operation and use to the product, so the product can better serve you.

***we will not notice if there is a change of product performance, if you want to know the latest features,please contact with the relevant business.***

## Table Of Contents

Chapter I Product Introduction	1
Chapter II Installation and Connection	4
2.1 Installation For the Alarm Control Panel	4
2.2 Insert the SIM card	4
2.3 Connection	5
2.4 Install wired detector	5
2.5 Install wireless detector	5
Chapter III Key description and Basic operation	6
3.1 Key description	6
3.2 Basic operation	7
3.3 LCD icon	8
3.4 System Arm and Disarm	9
3.5 Alarm procedure	10
Chapter IV Voice Alarm Receiving And GSM Control	11
4.1 Remote phone control	11
4.2 Alarm receiving phone operation	11
4.3 GSM control via SMS	12
Chapter V User Settings	13
5.1 Set User Password	13
5.2 Set Voice Phone	13
5.3 APP QR Code	13
Chapter VI System Setting	14
6.1 Set password	14
6.2 Set Network	15
6.2.1 DHCP	15
6.2.2 Host IP	16
6.2.3 Network gateway	16
6.2.4 Subnet mask	16
6.2.5 Preferred DNS	17
6.2.6 Standby DNS	17
6.2.7 WEB port	17

6.3 Set CMS	17
6.3.1 Phone CMS Enable	18
6.3.2 CMS Phone No. 1	18
6.3.3 CMS Phone No. 2	18
6.3.4 CMS user Number	18
6.3.5 CMS Dialing Times	19
6.3.6 Internet CMS Enable	19
6.3.7 Sever IP	20
6.3.8 Sever Port	20
6.3.9 Sever Account	20
6.3.10 Sever Password	20
6.3.11 Sever Heartbeat	21
6.4 Set Voice Phone	21
6.4.1 Set voice phone number	22
6.4.2 Dialing times	22
6.4.3 APP Server IP	22
6.5 System options	23
6.5.1 Entry Delay	23
6.5.2 Exit Delay	24
6.5.3 Siren Time	24
6.5.4 Sensor loss	25
6.5.5 AC off Delay Time	25
6.5.6 Comm Test	26
6.5.7 Arm/Disarm Tone	26
6.5.8 Arm/Disarm Report	26
6.5.9 Force Arming	27
6.5.10 Door Open Check	27
6.5.11 Sensor Tamper Check	28
6.5.12 Alarm Times	28
6.5.13 Emergency Siren Type	28
6.6 Wireless	29
6.6.1 Wireless Remote	29
6.6.2 Wireless Sensor	30
6.6.3 Wireless Switch	31

6.6.4 Wireless Siren	32
6.6.5 Wireless doorbell	33
6.7 Zone Management	34
6.8 Set Alarm Alert	35
6.9 SmartHome	37
6.10 Time	38
6.10.1 Auto time	38
6.10.2 Daylight-saving time	39
6.10.3 24-hour system	39
6.10.4 Time zone	39
6.10.5 Time	40
6.10.6 Timing Arm/Disarm	40
6.11 Restart	41
6.11.1 Restart	41
6.11.2 Delete logs	41
6.11.3 Factory default	42
6.12 Display	42
6.13 RFID	42
6.14 Others	43
6.14.1 Recording	43
6.14.2 Play	44
6.14.3 PGM	44
6.14.4 Chime Music	44
6.15 Corss zone	45
6.16 About	45
Chapter VII Web IE introduction	46
7.1 Remote Control	47
7.2 Password setting	48
7.3 CMS center setting	49
7.4 Network configuration	50
7.5 System Options	51
7.6 Voice Phone	52
7.7 Wireless Device	53
7.8 Zone Setting	53
7.9 RFID Setting	54

7.10 Event Log	55
7.11 Remote upgrade	56
7.12 System Reboot	57
7.13 Alert Setting	58
7.14 Email Setting	59
7.15 Time Setting	60
7.16 Home Automation	61
Chapter VIII APP User Manual	62
8.1 Create account	61
8.2 Modify the CMS account password	63
8.3 Add Cameras	64
Chapter IX Technical Specification	66
Chapter X Maintenance	67
Chapter XI Limitation of the Products	67





## Chapter I Product Introduction

1. Alarm Mode: With Internet network and GSM network alarm,GSM network with GPRS function,remote arm and disarm panel through CMS or SMS,CID protocol,SMS notification,the priority of Internet Network and 4G Network is Optional.
2. With a new color-screen, full-touch buttons, LCD graphic display steps,working status,alarm process easy and intuitive.
3. The full english voice prompting operation: all local or remote operation,alarm information,event log view.
4. GSM-hook and voice telephone with intercom function.
5. All alarm information can be programmed by 16 ways.
6. Sleep mode,in sleep mode status,all the lights,LCD backlight,voice and prompt tone are disabled.
7. Alarm panel under idle status is equivalent to a cellphone,you can call through the GSM network for balance inquiries.
8. 8 groups associated zone,can effectively reduce false alarm or for other functions.
9. PGM output: With a programmed output port,followed by 5 kinds of alarm events output.
10. The Doorbell Audio Optional: 1.Ding Dong 2. Welcome
11. Remote Phone operation: dialing by telephone offsite,after password verification,you can arm,disarm,listen-in premise,system status query and electrical switches controls and other operations.
12. Voice Alarm: When panel alarm,it will automatically dial the preset user phone numbers to report alarm information then you can remote control the panel after enter user passwords.
13. 32 wireless zones,each wireless zone can automatically learn the codes or be coded manually via the keyboard and web operation.
14. 8 wired zones,user can set the circuit type and speed of response,support N.O,N.C.
15. Enable enroll total 8 wireless remotes,16 electronic switches,1 wireless doorbell and unlimited for quantity of one way wireless siren,16 RFID tags.

- 16.** 6 follow me phone # (voice alarm receiving phone #), 2 for CMS, 4 for private alarm receiving.
- 17.** Status Inspection Functions: enable record and inquiry 512 alarm event messages. Like the time when happens anti-tamper alarm, detector alarm, tel-line off, arm, disarm, system setting, battery low voltage ect. And also can inquiry the zone number and alarm type.
- 18.** Timing Arm/Disarm: 4 sets of timing arm and disarm time.
- 19.** Electrical Switches Control: User can remote switch on/off via phone or SMS, also can be controlled manually through the local alarm panel.
- 20.** Zone Programmable: factory preset for each zone type. Users can modify all the zone type according to the actual needs .
- 21.** Clock: Built-in full automatic calendar clock, set to local time consistent.
- 22.** Password Access Management: the panel has one administrator password 16 user password, The administrator password primarily for system administrators to set up the alarm system; The user passwords for users in the day-to-day use such arm/ disarm, remote operation. The administrator password, user password can be freely modified.
- 23.** For CMS networking alarm, depending on the number of users, the user can set four user codes(account number).
- 24.** Zone type identification: After an alarm is triggered, the alarm zone number displayed on the LCD screen of the panel, also can send the detailed report to CMS which includes alarm locations and zone types.
- 25.** Alarm mode: stand-alone single-family use by the ordinary telephone alarm; it can also be connected to the Internet with the alarm center by the computer alarm. Alarm center automatically recognize and compatible with ordinary telephone alarm.
- 26.** The tampering alarm: cut the cable between wired detectors and the panel will trigger alarm.
- 27.** Anti-tamper function: When someone deliberately dismantled the panel, it will alarm when triggering tamper switch at the back of the panel.
- 28.** CMS communications test: The panel will send a message to CMS at the pre-set time interval to inspect the communication if normal.
- 29.** Siren options: Built-in siren, external wired siren, Wireless siren. All sirens can be programmed as enabled/disable when alarms.

**30.** The voice speaker volume adjustment: total 7 level, adjust the volume by a panel arrow keys.

**31.** Wireless repeater function: can extend the distance between the detector and the panel by adding a wireless repeater of our company.

**32.** The wireless detector low battery prompted: Detectors will send status report to the panel every 1-3 hours, the corresponding zone number and the battery voltage symbol will be displayed on the LCD screen and also will report to CMS.

## Schematic diagram of decomposition

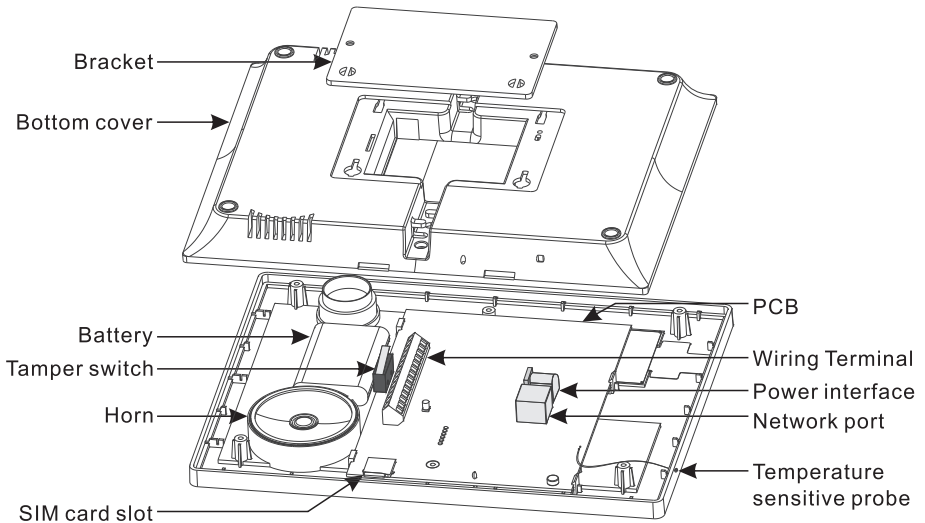

## Chapter II Installation and Connection

### 2.1 Installation

1) Please refer to the steps below

A. Push the bracket downward and separate it from the main panel, as shown in Figure 2-1.

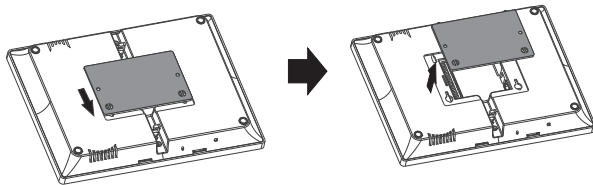

Figure 2-1

B. Fix the bracket on the wall with screw.  
C. Put the main panel on the bracket right, and push the main panel downward, as show in Figure 2-2.

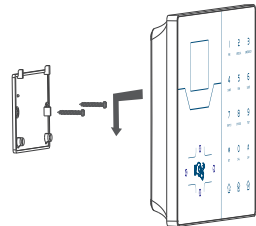

Figure 2-2

2) Please do not put big metal beside the main panel. They may effect the wireless RF signal.

3) When install the main panel, please pay much attention to the signal of RF detectors.

Make sure, all RF detectors are in the coverage area.

### 2.2 SIM card

Make sure the power is off ,when you insert the sim card as Figure 2-3  
4G will show in the up right of LCD display.

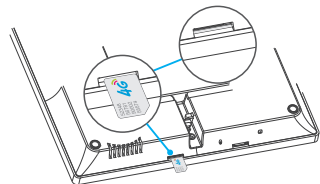
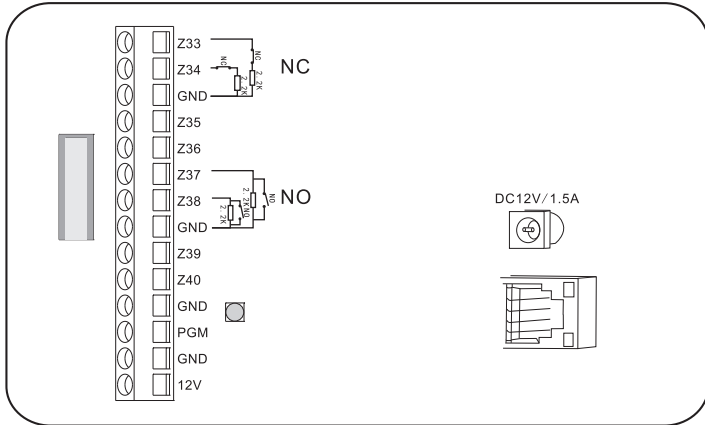

Figure 2-3

## 2.3 Connection (The wired zones support N.O.N.C detectors)

As pictures



Here only introduce the zone 33,34,37,38. The other zones please refer to the above.

## 2.4 Install wired detector

2.4.1 The wired zones is disabled factory default. When to use wired zones, please enable the zones firstly. When wired zones is in trouble, the panel will voice prompt "operation failed, Zone trouble" if users try to arm the panel. The zone number will be also display on the LCD screen. At this time arm system is not allowed unless you force arm.

2.4.2 The control panel can power 12V, 100mA to detectors. The max current is 100mA. Do not exceed 100mA, otherwise please use extra power supply.

## 2.5 Install wireless detector

2.5.1 As the detector's manual says, install coded detector in the area 150m from the control panel. Please make the walk testing and make sure detector can work with control panel normally.

2.5.2 Wireless repeater function: (product item No. PB-205R) when wireless detector is too far from the panel or some occluders between panel and detector which disable the panel receive the signal from wireless detector. Now you can choose the repeater to make wireless repeater to achieve wireless signal relay transmitting.

## Chapter III Key description and Basic operation

### 3.1 Key description

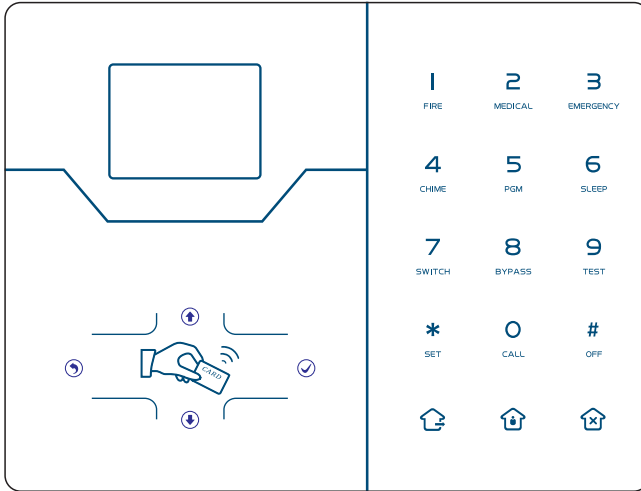

	Arm
	Home Arm
	Disarm
	RFID Card
	Up key
	Down key, System status/zone status/event log inquiry key
	Return key, volume reduction
	Confirm key, volume plus

1 FIRE	Press 3 seconds to trigger fire alarm
2 MEDICAL	Press 3 seconds for medical help
3 EMERGENCY	Press 3 seconds for SOS
4 CHIME	Press 3 seconds and enter user code to enable or disable delay zone door bell
5 PGM	Press 3 seconds then enter user code to enable or disable PGM output
6 SLEEP	Press 3 seconds to enter or exit sleep mode
7 SWITCH	Press 3 seconds then enter user code to enable or disable electrical power switch
8 BYPASS	Press 3 seconds then enter user code to bypass zones or activate zones
9 TEST	Press 3 seconds then enter user code to proceed normal testing,siren testing and walk testing
0 CALL	Press 0 for 3 seconds to make phone call through GSM, the talk time up to approximately 240 seconds
* SET	Set/Select down key
# OFF	Confirm/Open options key

**Sleep mode:** all LED indicators,backlight,voice,remind tone will be disabled under sleep mode, The panel will exit sleep mode automatically when users enter system setting or when alarm occurs.

**Bypass zone:** bypassed zones means zones disabled.Bypass zones will be canceled when users disarm systems under home armed or armed status.

**Communication test:** To test the communication between the panel and the CMS if normal.

**Siren test:** To test if siren working normal.

**Walk test:** To test if the detectors are working normally with the panel and alarm.

## 3.2 Basic operation

Factory default

Administrator password: 012345

16 User passwords,No.01 factory default is 1234.No.02-16 of the user password is blank and can not enter the user setting until user set the password.

**Disarm:** User password [1234]+Disarm key 

**Home arm:** Home arm key 

**Arm:** Arm key 

**Event Log:** Press Down key  to choose event log + 

**Shutdown:** AC power off firstly, in disarm status, Press # key for 3s, enter 1234# command.

**Enter System Setting:** Press \* key for 3s, enter admin password 01235# command.

**Enter User Setting:** Press \* key for 3s, enter 1st user password 1234# command.

**Zone Inspection:** Within 60s of AC power on, the system do not inspect wired zones.









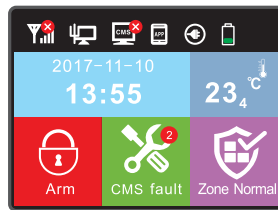



**Forget Password:** Shutdown firstly, within 60s of AC power on, press \* key for 3s, enter 000000# command to reset.



**Zone Inspection:** Do not inspect wired zones within one minute of panel power up.

**Notice:** Only under disarm status of panel, enter system settings and user settings.

## 3.3 LCD icon



Icon	Meaning	Icon	Meaning
	GSM signal strength		Network cable
	Enable Internet CMS		APP control
	Power supply		Built-in battery level
	Arm		System disarm
	Home arm		Temperature
	Fault prompt		Zone status

**1.System fault display:** Icon  indicates that the function has failed. If not access the network cable, the icon is shown as . When the network cable access, it shows normal.

**2.Zone fault display:** When the zone fails, Zone status corner icon shows the number of zone faults, the text below the icon shows the fault function. When the fault is removed, the icon shows “zone normal”.

The details of the faults can be queried by entering the user settings.

When panel alarm and user disarm, the screen still shows zone alarm, please disarm again, and the screen shows the zone normal.



## 3.4 System Arm and Disarm

### ☆ ARM

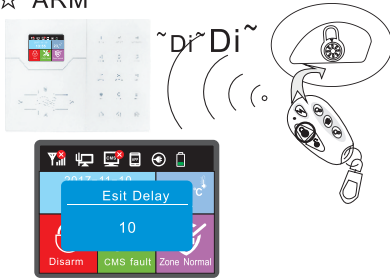

Press the arm key on remote or the keypad, then you hear system armed, please exit the protection area there will be Di-Di sound to confirm the system is armed successfully.

### ☆ DISARM

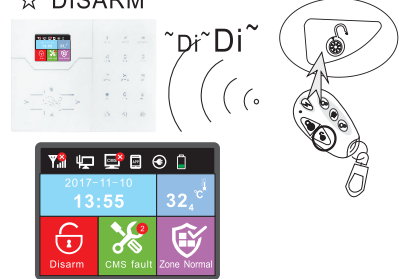

Press the disarm key on the remote or enter your user password on the keypad, then you will hear Di-Di and voice "system disarm", then you have disarm successfully.

### ☆ HOME ARM

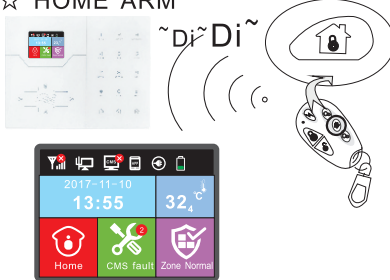

Press the key for home arm on the remote or HOME key on the keypad, then you will hear 'system stay' and it display home arm icon on the LCD screen.

### ☆ SOS



Press the panic button on remote, or press 3 key on panel for 3 seconds, it will trigger to alarm.

The codes of arm/disarm via different ways:

Arm/disarm via remote controllers: 1-8 remotes----#40-47

Arm/disarm via user codes: 1-16 user codes----#01-16

Arm/disarm via phone call: 1-4 user phone number ----#50-59

Arm/disarm via CMS: #60

Arm/disarm via auto timer or key zone: #80-81

Arm/disarm via RFID Card: #20-39

Arm/disarm via WEB Page: #70

Unknown control: #90

### 3.5 Alarm procedure

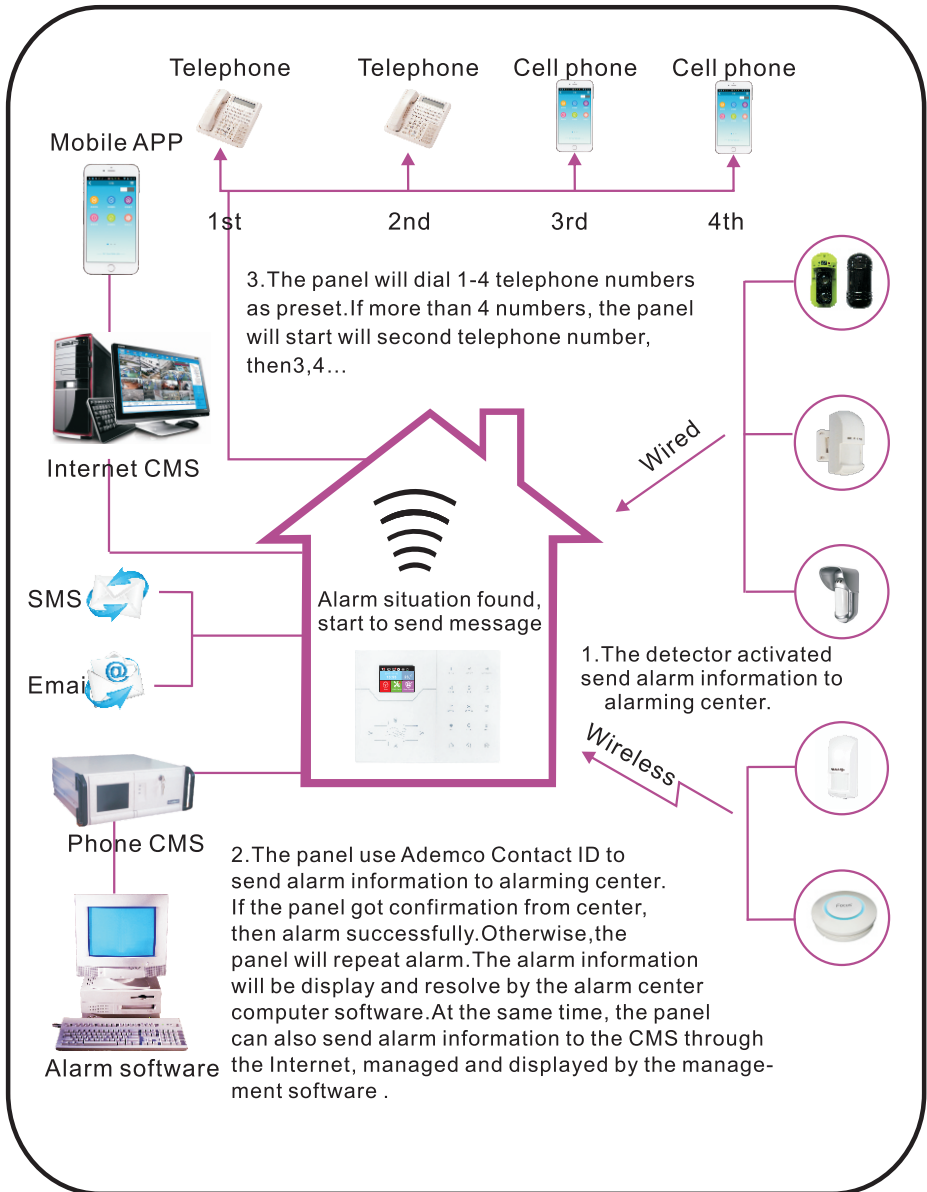

## Chapter IV Voice Alarm Receiving And GSM Control

### 4.1 Remote phone control

User make phone call to the GSM No.of the alarm control panel.Directly connect to the alarm control panel,according to the voice prompt to enter the user password as below photo.

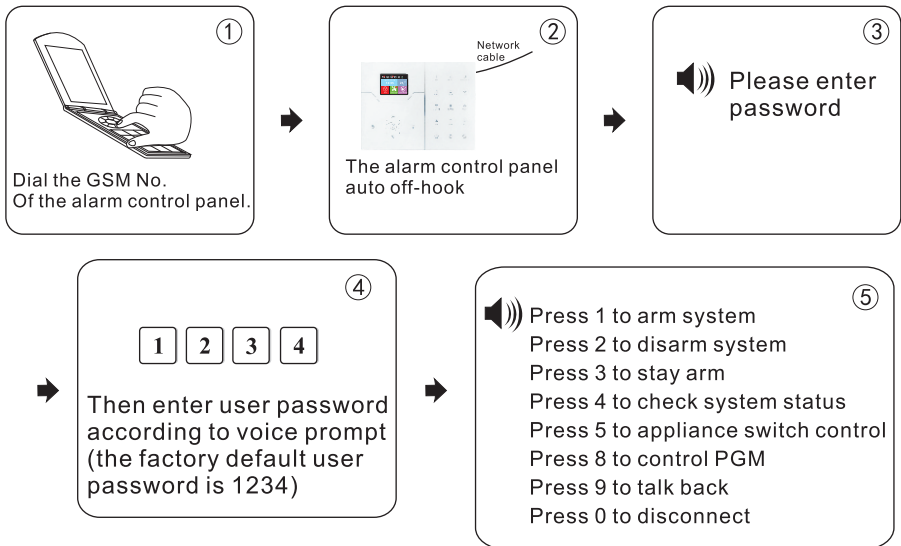

### 4.2 Alarm receiving phone operation

When alarm,the panel will dial the preset voice phone number,when the user pick up the call,they will hear the voice prompting as below, if not press 1 to cancel the alarm or press 4 to disarm the system,after off-hook,the panel will call other preset voice phone numbers.

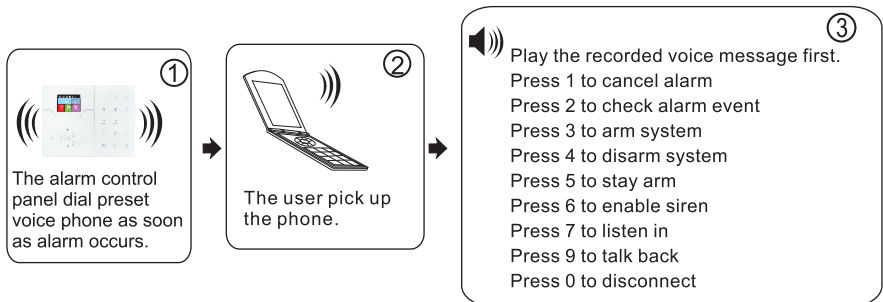

### 4.3 GSM control via SMS

Arm Command	#PWD1234 # ARM
Disarm Command	#PWD1234 #DISARM
Home Arm Command	#PWD1234 # HOME
Status Checking command	#PWD1234 # CHECK
Enable programmable output port	#PWD1234 # PGM OPEN
Disable programmable output port	#PWD1234 # PGM CLOSE
Enable appliance switch command	#PWD1234 # SWITCH OPEN <b>XX</b> (XX=01-16 on behalf of appliance switch number)
Disable appliance switch command	#PWD1234 # SWITCH CLOSE <b>XX</b> (XX=01-16 on behalf of appliance switch number)

**Note:**

**1, the factory default user code is 1234, when arm successfully, SMS auto reply ‘ arm successfully’ , if the password is correct, the command is not correct, SMS will reply ‘ operation failure’ , if the password is not correct, no SMS reply.**

**2, 'FOR Enable/disable the appliance switch**

**#PWD1234 # SWITCH OPEN **XX**(01-16)**

**XX is for electric switch serial number from 01-16, there is space between ‘ OPEN’ and ‘XX’**

## Chapter V User Settings

Press [\*] for 3 seconds



### 5.1 Set User Password

For example: set No.2 use password as 5678

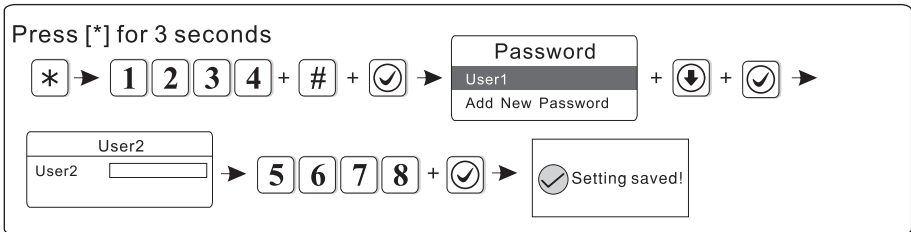

*Note: Can set 16 user passwords, corresponding password No. From 01 to 16, Only No.1 password can enter user setting.*

### 5.2 Set Voice Phone( refer to 6.4)

### 5.3 APP QR Code

APP QR Code only for alarm panel. Add a login account by scanning the QR code.

## Chapter VI System Setting

Press[\*]for 3 seconds, voice prompt “please enter password”

\* + 0 1 2 3 4 5 + # →



### 6.1 Set password

Press[\*]for 3 seconds, voice prompt “please enter password”

\* + 0 1 2 3 4 5 + # + [Down Arrow] [Checkmark] the following operations can be performed :

①Set admin password

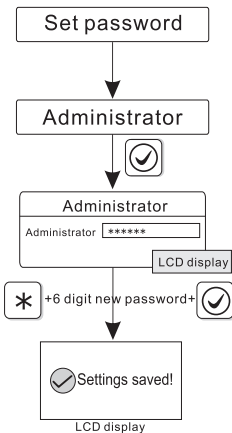

②Set user 1 password

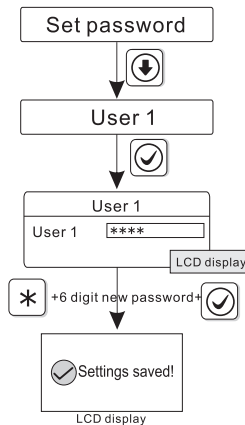

③Add new password:

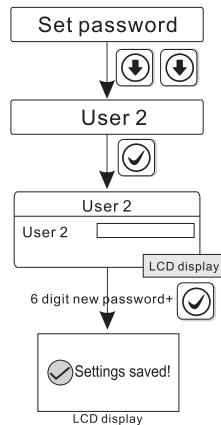

**Note:** Password setting is included user password and administrator password. user password mainly use to disarm the system, it is a private key for remote controlling, Administrator password is the sole password to set the system.

2. Administrator password is 6 digit, user password is 4 digit, can set 16 user password, corresponding password No. from 01 to 16, but No.02-16 password can not enter user setting.

For example: Set admin password as 888888

Press[\*]for 3 seconds

\* → Enter password + 0 1 2 3 4 5 + # + [Down Arrow] [Checkmark] + \*

+ 8 8 8 8 8 8 + [Checkmark] → [Settings saved!]

After the setting is completed, the screen will automatically return to the upper interface

LCD display

**Note:1.** Above base on the correct operation, if incorrect operation occurs, please press back key to back previous menu.

**2.**The factory default of admin password is 012345, user password is 1234, if you have modified the password, please refer to the new password.

## 6.2 Set Network

Press [\*]for 3 seconds, voice prompt"please enter password"

\* + 0 1 2 3 4 5 + # + [Down Arrow] [Checkmark]

Press 2 times

- DHCP
- IP
- Gateway
- Subnet Mask
- Preferred DNS
- Alternate DNS
- Web Port

**Note:** Just can set host IP, gateway, subnet mask and DNS when DHCP is disabled.

### 6.2.1 DHCP

Enabled DHCP means using DHCP server to assign IP address, subnet mask and default gateway automatically.(default is enabled)

For example: Disabled DHCP

Press[\*]for 3 seconds

\* → Enter password + 0 1 2 3 4 5 + # + [Down Arrow] [Down Arrow] [Checkmark] + [Checkmark]

+ 0 + [Checkmark] → [Settings saved!]

LCD display

0 is disabled, 1 is enabled  
After the setting is completed, the screen will automatically return to the upper interface

## 6.2.2 Host IP

- ① The default DHCP function is enabled, please disabled DHCP when you set host IP.
- ② User need to set up the network parameters according to the actual network environment . when there are more panels in the same network, the IP of panels must be different.
- ③ Setting the IP address, if it is not enough 3 digits, please fill in the 0 before the digits,for example “192.168.1.81”, need to enter “192168001081” from keypad. after setting IP address, then exit system setting and auto restart to make the setting in valid.*Note: when DHCP is enabled, this setting is invalid.*  
For example: Set IP as 192.168.3.82

Press[\*]for 3 seconds

After the setting is completed, the screen will automatically return to the upper interface.

## 6.2.3 Network gateway

User can set network gateway according to the local actual conditions, for example:set gateway as 192.168.3.1

Press[\*]for 3 seconds

Press 2 times

After the setting is completed, the screen will automatically return to the upper interface.

## 6.2.4 Subnet mask

For example: set Subnetmaks as 255.255.255.240

Press[\*]for 3 seconds

Press 3 times

After the setting is completed, the screen will automatically return to the upper interface.



## 6.2.5 Preferred DNS

For example: set preferred DNS as 202.096.128.086

Press[\*]for 3 seconds

\* → Enter password + 0 1 2 3 4 5 + # + [Down Arrow] [Down Arrow] [Checkmark] + [Down Arrow] Press 4 times

[Checkmark] + 2 0 2 0 9 6 1 2 8 0 8 6 + [Checkmark] → [Checkmark] Settings saved!  
LCD display

After the setting is completed, the screen will automatically return to the upper interface

## 6.2.6 Standby DNS

Please refer to the above operation method.

## 6.2.7 WEB port

Please refer to the above operation method.

## 6.3 Set CMS

Press [\*] for 3 seconds,  
 voice prompt "Please enter password"

\* + 0 1 2 3 4 5 + # + [Down Arrow] [Checkmark] → Press 3 times

- Phone CMS Enable
- CMS Phone No. 1
- CMS Phone No. 2
- CMS user Number
- CMS Dialing Times
- Internet CMS Enable
- Sever IP
- Sever Port
- Sever Account
- Sever Password
- Sever Heartbeat

## 6.3.1 Phone CMS Enable (the default is enabled)

For example: make phone alarm platform disabled

Press[\*]for 3 seconds

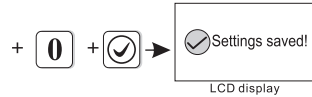

0 is disabled, 1 is enabled, after the setting is completed, the screen will automatically return to the upper interface

## 6.3.2 CMS Phone No. 1

When alarm is triggered, the panel will dial CMS telephone number to inform central monitor server, CMS telephone number max.17 digits.

For example: Set CMS telephone number as 80012345

Press[\*]for 3 seconds



After the setting is completed, the screen will automatically return to the upper interface

## 6.3.3 CMS Phone No. 2

Please refer to 6.3.2

## 6.3.4 CMS user Number

The user No. is the identity code of the user at the alarm center.

For example: set user No. as 1701

Press[\*]for 3 seconds

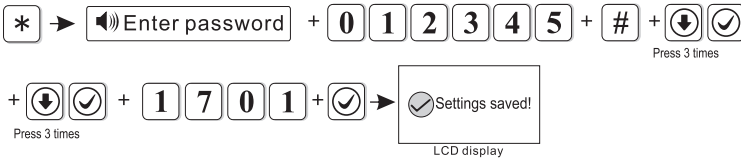

After the setting is completed, the screen will automatically return to the upper interface.

## 6.3.5 CMS Dialing Times

When alarm happens, the device will dial the CMS telephone no.1 and no.2 the factory default is 5 times, if the call is still not answered after 5 times, it will stop to dial out . for example: set dial times as 8.

Press[\*]for 3 seconds

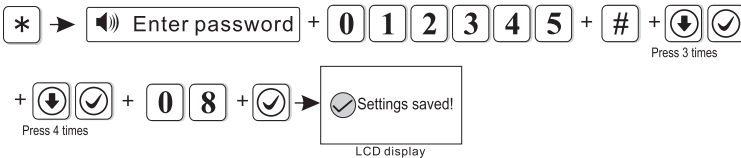

Dial times can be set as 1-15, high perch fill 0 when less than 2 bits. After the setting is completed, the screen will automatically return to the upper interface.

## 6.3.6 Internet CMS Enable(the default is disabled)

For example: Enable network platform.

Press[\*]for 3 seconds

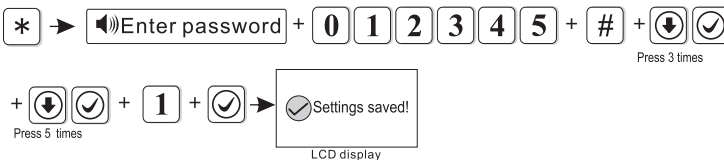

0 is disabled, 1 is enabled, after the setting is completed, the screen will automatically return to the upper interface.

## 6.3.7 Server IP

For example: set server IP as 192.168.1.66

Press[\*]for 3 seconds

After the setting is completed, the screen will automatically return to the upper interface.

## 6.3.8 Server Port

For example: set server port as 5679 (default is 7974)

Press[\*]for 3 seconds

After the setting is completed, the screen will automatically return to the upper interface.

## 6.3.9 Server Account

For example: set server register ID as 02001010.

Press[\*]for 3 seconds

Register ID can be set up to 8 digits at most,  
After the setting is completed, the screen will automatically return to the upper interface.

## 6.3.10 Server Password

For example: set server register password as 12345678

Press[\*]for 3 seconds

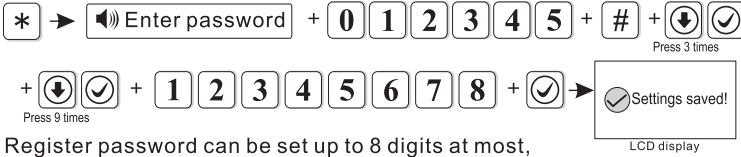

Register password can be set up to 8 digits at most,  
After the setting is completed, the screen  
will automatically return to the upper interface.

## 6.3.11 Server Heartbeat

Heartbeat time means the time interval that the device sending info to platform. every interval heartbeat time, the device will send heartbeat info to the platform. if the platform can not receive several heartbeat info, this device will be considered as offline, and record this offline in the platform data.

For example: set heartbeat time as 40s(heartbeat time is 1-255s,default is 25s)

Press[\*]for 3 seconds

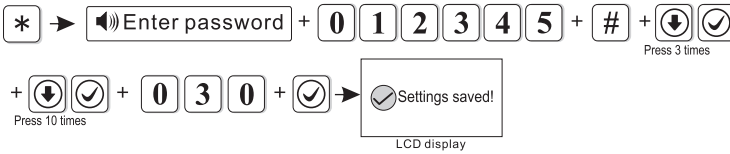

Heartbeat time can be set from 1-255, high perch fill 0 when less than 3 bits  
After the setting is completed, the screen  
will automatically return to the upper interface.

## 6.4 Set Voice Phone

Press[\*]for 3 seconds, voice prompt"please  
enter password"

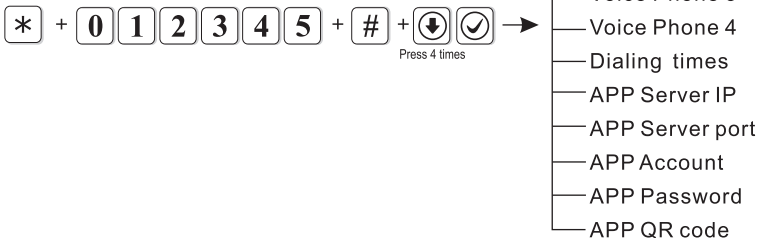

## 6.4.1 Set voice phone number

When alarm happens, the device will dial user's phone no., it can set 4 voice phone no. each phone number can be set up to 17 digits at most. For example: set voice phone 3 as 12345678

Press[\*]for 3 seconds

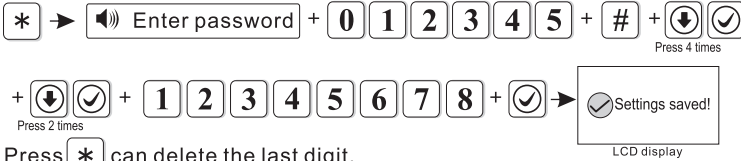

Press [\*] can delete the last digit, After the setting is completed, the screen will automatically return to the upper interface.

## 6.4.2 Dialing times

Default is 5 times.

For example: set voice phone dial times as 6.

Press[\*]for 3 seconds

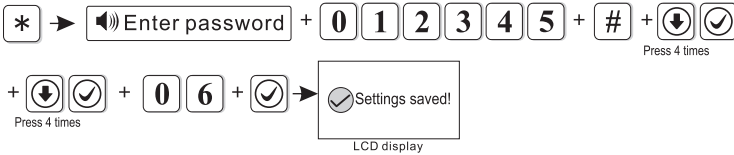

The dial times can be set as 1-15, high perch fill 0 when less than 2 bits. After the setting is completed, the screen will automatically return to the upper interface.

## 6.4.3 APP Server IP

①Set App server: default is 119.147.144.090

For example: set App server IP as 114.184.162.081

Press[\*]for 3 seconds

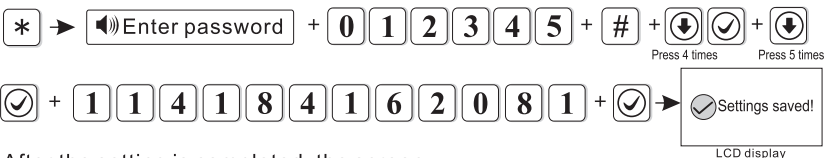

After the setting is completed, the screen will automatically return to the upper interface.

- ②**APP Server Port:** default is 18034
- ③**APP Account:** same as panel's ID, for example1AB7113E.
- ④**APP Password:** Network forwarding platform APP login password, default is 12345678, user can change it, can enter 16 digits.
- ⑤**APP QR code:** can login App via scan QR code, please download App via scan below QR code.



## 6.5 System options

Press[\*]for 3 seconds, voice prompt “please enter password”



- Entry Delay
- Exit Delay
- Siren Time
- Sensor loss
- AC off Delay Time
- Comm Test
- Arm/Disarm Tone
- Arm/Disarm Report
- Force Arming
- Door Open Check
- Sensor Tamper Check
- Alarm Times
- Emergency Siren Type

### 6.5.1 Entry Delay

When trigger delay zone, the panel will delay to alarm( default is 10s)  
For example: set entry delay time as 20s

Press[\*]for 3 seconds

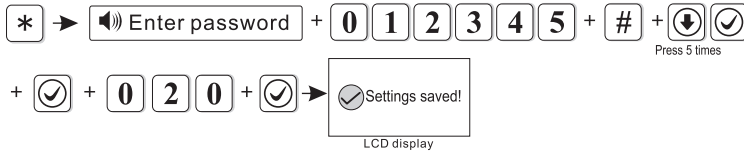

The entry delay time can be set from 1-255, high perch fill 0 when less than 3 bits. After the setting is completed, the screen will automatically return to the upper interface.

*Note: the entry delay is only valid for the delay zone, other types of zone without delay.*

## 6.5.2 Exit Delay

After user arming the system, the user has enough time to exit the protection area. ( exit delay time is 1-255s, default is 10s)

For example: set exit delay time as 20s.

Press[\*]for 3 seconds

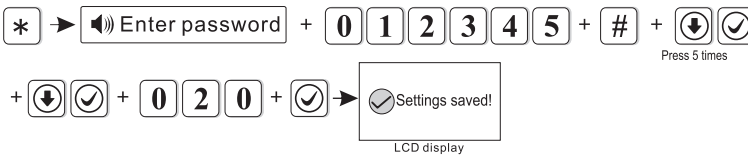

The entry delay time can be set from 1-255, high perch fill 0 when less than 3 bits. After the setting is completed, the screen will automatically return to the upper interface.

## 6.5.3 Siren Time

Siren time is 1-30 minutes, the default is 5 minutes.

For example: set siren time as 10 minutes.

Press[\*]for 3 seconds

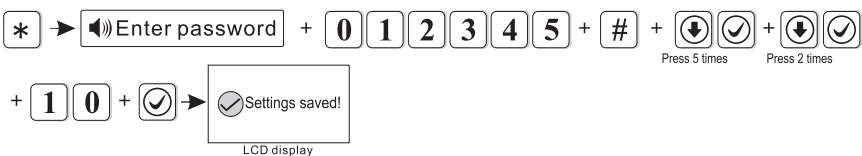

The siren time can be set from 1-30, high perch fill 0 when less than 2 bits. After the setting is completed, the screen will automatically return to the upper interface.



## 6.5.4 Sensor loss

In the set time period, the panel will detect if receive the status report or alarm info from the detector, if not receive, this detector will be regarded as loss, recommended loss inspection time not less than 6 hours.

( default is 0, disabled)

For example: set detector loss inspection time as 8 hours.

Press[\*]for 3 seconds

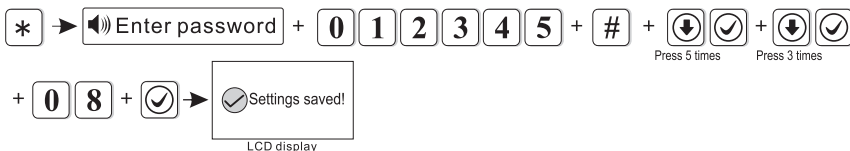

The detector loss inspection time can be set from 0-99, high perch fill 0 when less than 2 bits. after the setting is completed, the screen will automatically return to the upper interface

## 6.5.5 AC off Delay time

It means the time when AC off, the device will delay to report to CMS.

(0-99 minutes, default is 30 minutes)

For example: set AC off inspection time as 15 minutes.

Press[\*]for 3 seconds

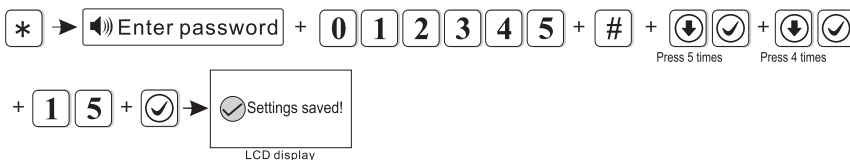

The AC off inspection time can be set from 0-99, high perch fill 0 when less than 2 bits. after the setting is completed, the screen will automatically return to the upper interface

- Note:**
1. this function mainly use for the area with unstable power
  2. when AC recovery in delay time, it will not send report to CMS.

## 6.5.6 Comm Test

Within this period, the alarm panel will send a test signal to the CMS to check if communication is working. (Factory default is 0, disable)

E.g. Set communication test period as 3h.

Press[\*]for 3 seconds

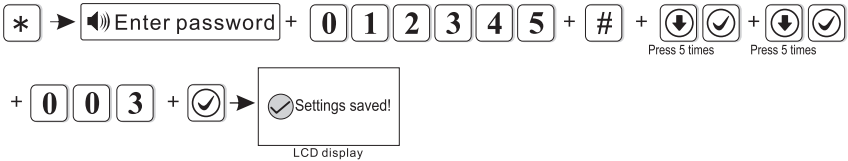

The communication test interval time can be set from 0-999, high perch fill 0 when less than 3 bits. after the setting is completed, the screen will automatically return to the upper interface

## 6.5.7 Arm/Disarm Tone

When user arm/disarm through remote controller, if siren will sound or not for prompting.(default is disabled)

For example: set arm/disarm tone is enabled.

Press[\*]for 3 seconds

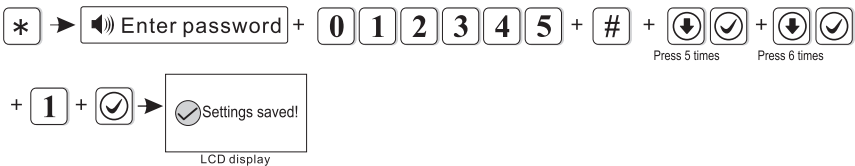

0 is disabled, 1 is enabled, after the setting is completed, the screen will automatically return to the upper interface.

## 6.5.8 Arm/Disarm Report

Set whether to upload the arm and disarm report to the center (not upload by default)

Example: set arming and disarming information to the center.

Press[\*]for 3 seconds

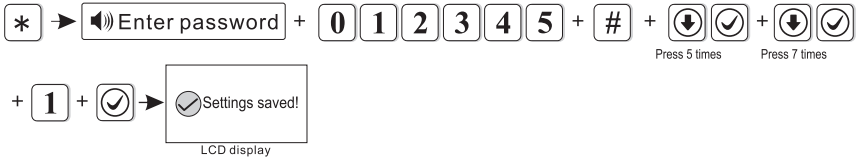

0 is disable, 1 is enable. After the setting is completed, the screen will automatically return to the upper interface.

## 6.5.9 Force Arming

If unable to set force arm, when there is zone trouble, the system can be armed and report the trouble zone s bypass message to CMS. If disable the force arm, the system can not be armed(factory default is disable force arm)  
Example: enable force arm.

Press[\*]for 3 seconds

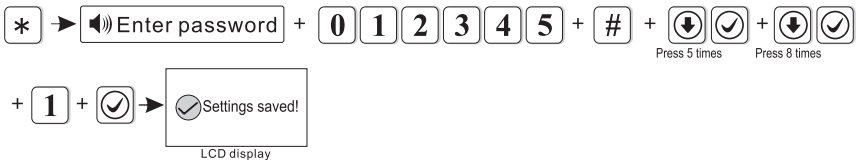

0 is disable, 1 is enable. After the setting is completed, the screen will automatically return to the upper interface.

## 6.5.10 Door Open Check

Set if the alarm panel show zone trouble on LCD screen or not when separate the magnetic strip from transmitter. (Factory default disable the inspection)  
Example: enable the magnetic contact inspection

Press[\*]for 3 seconds

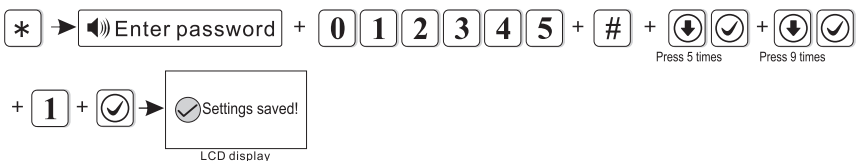

0 is disable, 1 is enable. After the setting is completed, the screen will automatically return to the upper interface.

## 6.5.11 Sensor Tamper Check

If the enable the checking when trigger the detector s tamper , will trigger alarm. If disable the checking, it will not trigger alarm.(factory default enable the checking)Example: disable the checking of wireless detector tamper.

Press[\*]for 3 seconds

\* → Enter password + 0 1 2 3 4 5 + # +     
 Press 5 times

+   + 0 +  →  Settings saved!   
 Press 10 times   
 LCD display

0 is disable, 1 is enable. After the setting is completed, the screen will automatically return to the upper interface.

## 6.5.12 Alarm Times

If set the alarm alarm times as 3, when zone start alarm but the zone is trigger 3 times again, the panel will not make alarm.(factory default is disabled)

E.g. set zone alarm times as 3 time

Press[\*]for 3 seconds

\* → Enter password + 0 1 2 3 4 5 + # +     
 Press 5 times

+   + \* +  →  Settings saved!   
 Press 11 times   
 LCD display

\* switch selection,After the setting is completed, the screen will automatically return to the upper interface.

## 6.5.13 Emergency Siren Type( the default setting is mute)

For example: set emergency alarm siren type is pedal point.

Press[\*]for 3 seconds



\* switch selection, After the setting is completed, the screen will automatically return to the upper interface.

## 6.6 Wireless

Press \* for 3 seconds, voice prompting "enter password".



### 6.6.1 Wireless Remote

Press[\*]for 3 seconds

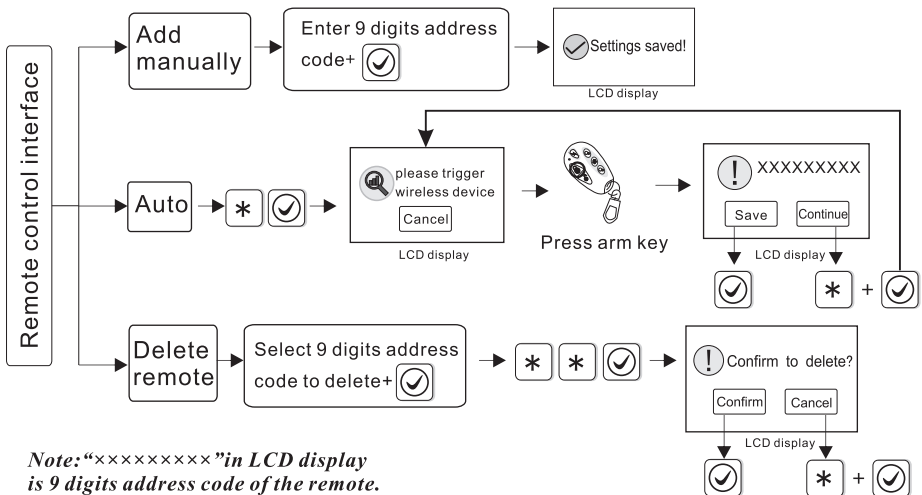

Support 8 remote control at max.

E.g: Add address code (112005123) of the remote automatically.

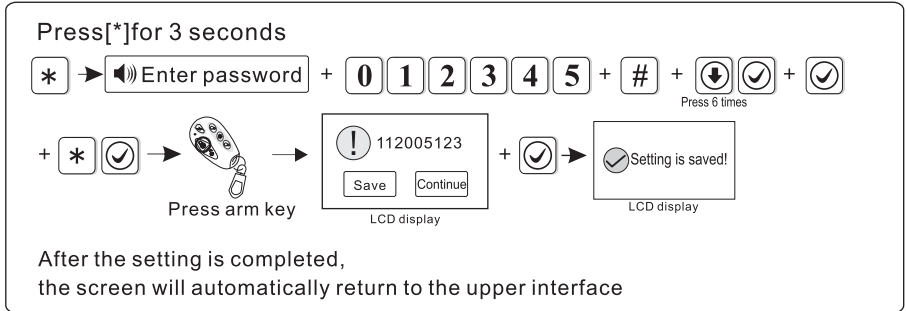

## 6.6.2 Wireless Sensor

Press[\*]for 3 seconds

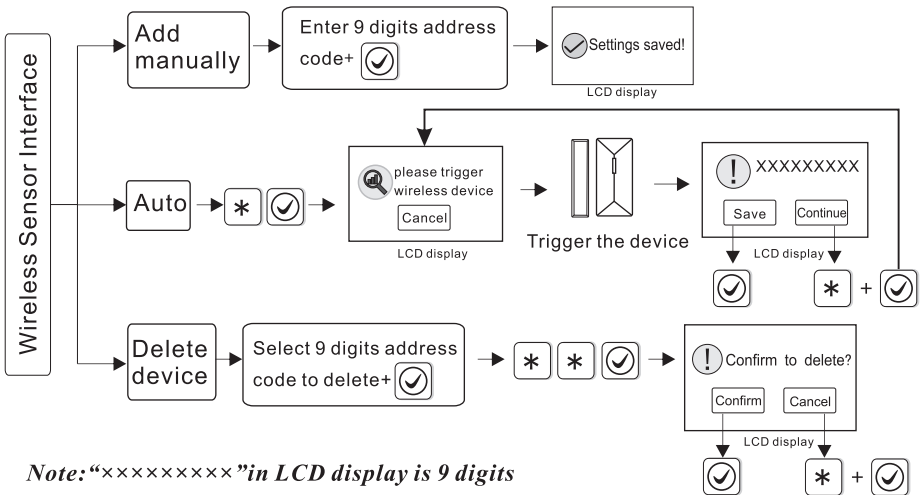

Support 32 wireless detectors at max, the zone number will be the order of detectors added.

E.g.: Delete the address code (118006123) of the detectors

Press[\*]for 3 seconds

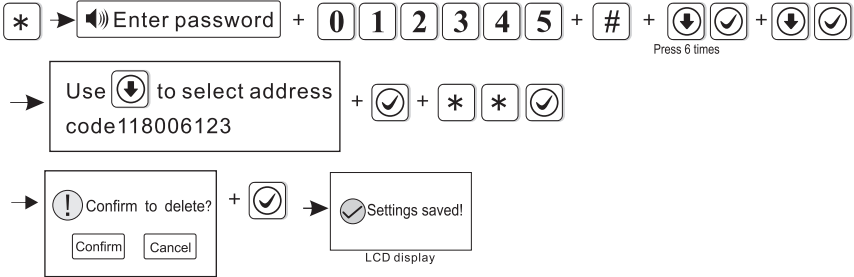

After the setting is completed, the screen will automatically return to the upper interface

## 6.6.3 Wireless Switch

Press[\*]for 3 seconds

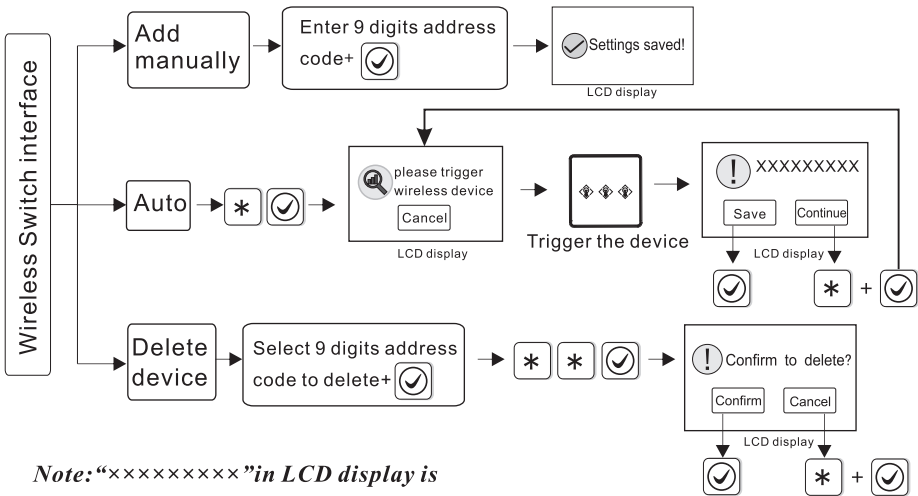

**Note:**“XXXXXXXXXX”in LCD display is 9 digits address code of the wireless electrical switch.

Support 16channel Wireless Electrical Switch at max.  
E.g.: Add address code (100112123) of electrical switch manually.

Press[\*]for 3 seconds

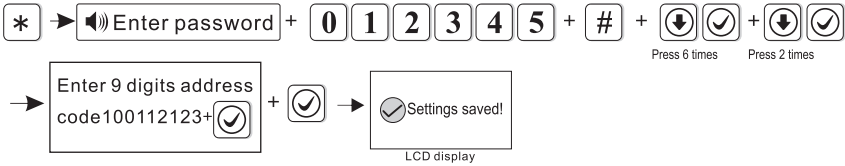

After the setting is completed, the screen will automatically return to the upper interface

## 6.6.4 Wireless Siren

Support one dual-way siren, countless one-way siren.

Press[\*]for 3 seconds

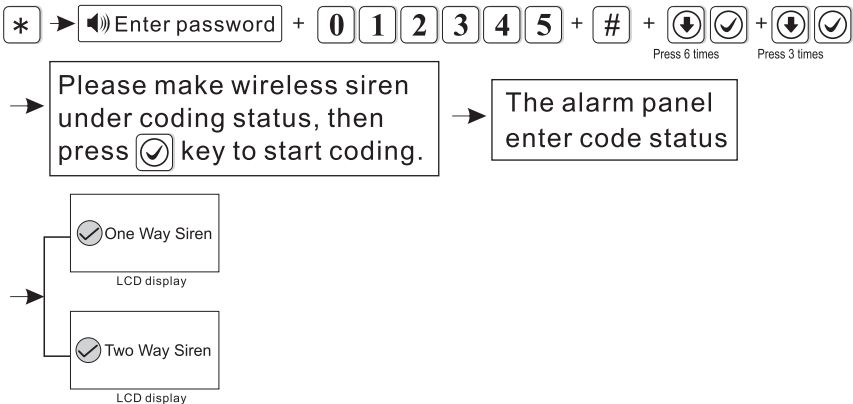

If it is a two-way wireless alarm, the screen will display its address code. After the setting is completed, the screen will automatically return to the upper interface

**Note:** When tamper alarm from the dual-way siren, the alarm panel will show zone 41 alarm. Only one dual-way wireless siren can be added, but no limits for one way wireless siren. If need to add both dual way and one way siren, please add dual way siren at last.



## 6.6.5 Wireless doorbell

Press[\*]for 3 seconds

+ + + + 
 After that, the following operations can be carried out:

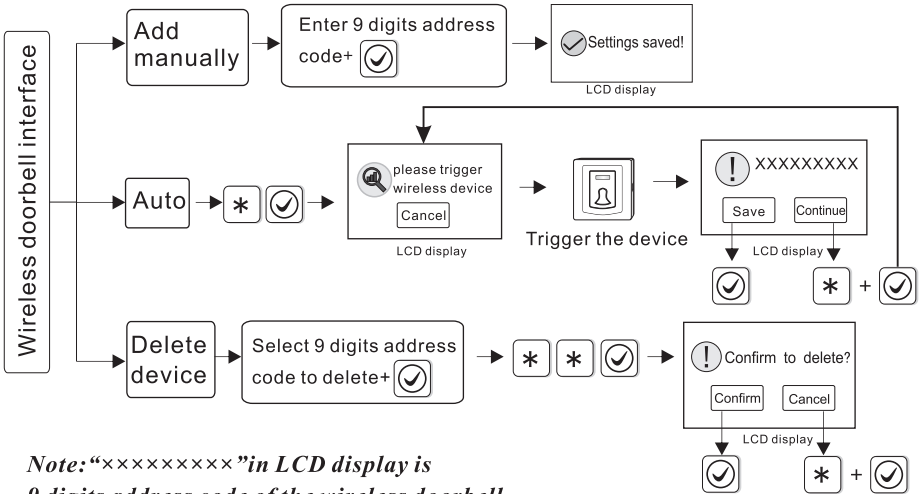

**Note:** “XXXXXXXX” in LCD display is 9 digits address code of the wireless doorbell.

E.g. Add address code (112102118) of doorbell.

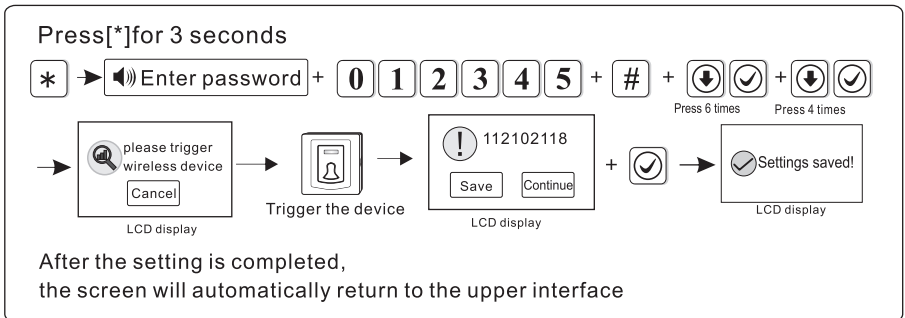

After the setting is completed, the screen will automatically return to the upper interface

## 6.7 Zone Management

Press \* for 3 seconds, voice prompting “enter password”.

\* + 0 1 2 3 4 5 + # +   can set zone type  
Press 7 times

Zone 1-32 is for wireless device, Zone 32-40 is for wired device. User can set zone type, zone alarm siren type and chime function.

*Instruction: \* is downward selection, # is open option from LCD screen operations.*

### ① Zone Type

The type of zone attribution is as below

>disable zone      > delay zone                      > perimeter zone  
 >interior zone      >emergency zone                      > 24 hours zone  
 >fire zone              > key zone(only for zone 33-40)

**A.**Zone attribution is the alarm type of the zone display on the alarm panel’s LCD screen when the zone is triggered. When set the zone attribution as 0 is to disable the zone. The alarm panel will not make alarm when trigger this zone.

**B.**interior zone only trigger alarm when the zone is triggered in armed status.

**C.**delay and perimeter zone trigger alarm when the zone is triggered in armed or home arm status.

**D.**emergency zone, 24 hours zone, fire zone will trigger alarm when system are in any status.

**E.**wireless zone can not set key zone type. When wired zone is set as key zone, trigger the zone, system turn to disarm status. The zone restore, system turn to armed status. This is available to access control system.

**F.**Key zone is used only for wired zone(33-40 zone)

### ② set zone siren type

User can set three type: Continuous, pulse, Mute (factory default is Continuous)

### ③ Chime Function

When the detector as delay zone, once it is triggered, the alarm panel will sound “dingdong” or “welcome”, optional. Factory default is disabled.

**Factory default:**

Zone	Zone Type	Siren type	Chime
1~2	Delay	Continuous	Disabled
3~32	Burglar	Continuous	Disabled
33~40	Disabled	Continuous	Disabled

E.g.: set zone 39 as key zone

Press[\*]for 3 seconds

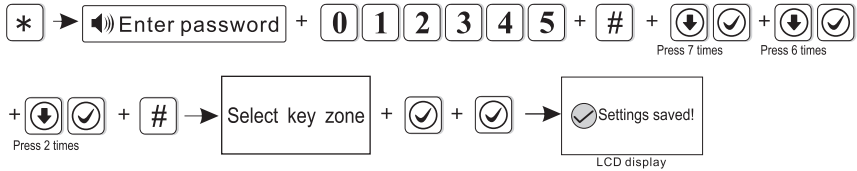

Press [\*] mobile, according to [#] open selection, After the setting is completed, the screen will automatically return to the upper interface.

## 6.8 Set Alarm Alert

Press \* for 3 seconds, voice prompting “enter password”.



Press [#] to select alarm type, press [#] again to enable/disable alert path.

:enable    :disable

**Factory default:**

Alarm Alert Type	Factory Default			
	CMS	Voice Phone	SMS	Email
Delay	<input checked="" type="checkbox"/>	<input checked="" type="checkbox"/>	<input checked="" type="checkbox"/>	<input type="checkbox"/>
Perimeter	<input checked="" type="checkbox"/>	<input checked="" type="checkbox"/>	<input checked="" type="checkbox"/>	<input type="checkbox"/>
Interior	<input checked="" type="checkbox"/>	<input checked="" type="checkbox"/>	<input checked="" type="checkbox"/>	<input type="checkbox"/>
Emergency	<input checked="" type="checkbox"/>	<input checked="" type="checkbox"/>	<input checked="" type="checkbox"/>	<input type="checkbox"/>
24 Hour	<input checked="" type="checkbox"/>	<input checked="" type="checkbox"/>	<input checked="" type="checkbox"/>	<input type="checkbox"/>
Fire	<input checked="" type="checkbox"/>	<input checked="" type="checkbox"/>	<input checked="" type="checkbox"/>	<input type="checkbox"/>
Panic	<input checked="" type="checkbox"/>	<input checked="" type="checkbox"/>	<input checked="" type="checkbox"/>	<input type="checkbox"/>
Tamper	<input checked="" type="checkbox"/>	<input checked="" type="checkbox"/>	<input checked="" type="checkbox"/>	<input type="checkbox"/>

Alarm Alert Type	Factory Default			
	CMS	Voice Phone	SMS	Email
System Away	<input checked="" type="checkbox"/>	<input type="checkbox"/>	<input checked="" type="checkbox"/>	<input type="checkbox"/>
System Disarm	<input checked="" type="checkbox"/>	<input type="checkbox"/>	<input checked="" type="checkbox"/>	<input type="checkbox"/>
System Stay	<input checked="" type="checkbox"/>	<input type="checkbox"/>	<input checked="" type="checkbox"/>	<input type="checkbox"/>
System low battery	<input checked="" type="checkbox"/>	<input type="checkbox"/>	<input checked="" type="checkbox"/>	<input type="checkbox"/>
AC loss	<input checked="" type="checkbox"/>	<input type="checkbox"/>	<input checked="" type="checkbox"/>	<input type="checkbox"/>
AC Restore	<input checked="" type="checkbox"/>	<input type="checkbox"/>	<input checked="" type="checkbox"/>	<input type="checkbox"/>
Alarm Cancel	<input checked="" type="checkbox"/>	<input type="checkbox"/>	<input checked="" type="checkbox"/>	<input type="checkbox"/>
Sensor Low Battery	<input checked="" type="checkbox"/>	<input type="checkbox"/>	<input type="checkbox"/>	<input checked="" type="checkbox"/>
Sensor bat Recovery	<input checked="" type="checkbox"/>	<input type="checkbox"/>	<input type="checkbox"/>	<input checked="" type="checkbox"/>
RF lost	<input checked="" type="checkbox"/>	<input type="checkbox"/>	<input type="checkbox"/>	<input checked="" type="checkbox"/>
Programming Changed	<input checked="" type="checkbox"/>	<input type="checkbox"/>	<input type="checkbox"/>	<input checked="" type="checkbox"/>
Arm Failed	<input checked="" type="checkbox"/>	<input type="checkbox"/>	<input type="checkbox"/>	<input checked="" type="checkbox"/>
Periodic Test Report	<input checked="" type="checkbox"/>	<input type="checkbox"/>	<input type="checkbox"/>	<input checked="" type="checkbox"/>
Zone Bypass	<input checked="" type="checkbox"/>	<input type="checkbox"/>	<input type="checkbox"/>	<input checked="" type="checkbox"/>
System Bat Restore	<input type="checkbox"/>	<input type="checkbox"/>	<input type="checkbox"/>	<input checked="" type="checkbox"/>
Communication Trouble	<input type="checkbox"/>	<input type="checkbox"/>	<input type="checkbox"/>	<input checked="" type="checkbox"/>
Zone Bypass Cancel	<input type="checkbox"/>	<input type="checkbox"/>	<input type="checkbox"/>	<input checked="" type="checkbox"/>
Communication Restore	<input type="checkbox"/>	<input type="checkbox"/>	<input type="checkbox"/>	<input checked="" type="checkbox"/>
Loop Open/Short	<input type="checkbox"/>	<input type="checkbox"/>	<input type="checkbox"/>	<input type="checkbox"/>
Loop Restore	<input type="checkbox"/>	<input type="checkbox"/>	<input type="checkbox"/>	<input type="checkbox"/>
Bell Troubl	<input type="checkbox"/>	<input type="checkbox"/>	<input type="checkbox"/>	<input type="checkbox"/>
Bell Restore	<input type="checkbox"/>	<input type="checkbox"/>	<input type="checkbox"/>	<input type="checkbox"/>
Duress	<input checked="" type="checkbox"/>	<input type="checkbox"/>	<input checked="" type="checkbox"/>	<input type="checkbox"/>
Entry/Exit Recovery	<input type="checkbox"/>	<input type="checkbox"/>	<input type="checkbox"/>	<input type="checkbox"/>
Perimeter Recovery	<input type="checkbox"/>	<input type="checkbox"/>	<input type="checkbox"/>	<input type="checkbox"/>

Alarm Alert Type	Factory Default			
	CMS	Voice Phone	SMS	Email
Burglary Recovery	<input type="checkbox"/>	<input type="checkbox"/>	<input type="checkbox"/>	<input type="checkbox"/>
Panic Recovery	<input type="checkbox"/>	<input type="checkbox"/>	<input type="checkbox"/>	<input type="checkbox"/>
24 Hour Recovery	<input type="checkbox"/>	<input type="checkbox"/>	<input type="checkbox"/>	<input type="checkbox"/>
Fire Recovery	<input type="checkbox"/>	<input type="checkbox"/>	<input type="checkbox"/>	<input type="checkbox"/>
Emergency Recovery	<input type="checkbox"/>	<input type="checkbox"/>	<input type="checkbox"/>	<input type="checkbox"/>
Tamper Recovery	<input type="checkbox"/>	<input type="checkbox"/>	<input type="checkbox"/>	<input type="checkbox"/>
RF Loss Recovery	<input type="checkbox"/>	<input type="checkbox"/>	<input type="checkbox"/>	<input type="checkbox"/>

Duress password: **1** + **1** **2** **3** **4** + 

user password

When you enter the duress password, you will trigger an duress alarm. If enter duress password When the system is under arm status, keypad will display system is disarmed, stop siren but send alarm info and alarm call. (pls set the CMS phone # and follow me phone #)

Example, A arm the system, B enter the area and trigger alarm, B threaten A disarm the system. A enter the duress password. The alarm panel will show disarm status but will send alarm info can call.

For example: Set perimeter alarm to open all sending paths.

(Perimeter alarm default only to close the mail)

Press[\*]for 3 seconds

**\*** →  Enter password + **0** **1** **2** **3** **4** **5** + **#** +   + **#**

Press 8 times

→  +  +  + **#** +  → 

Press 4 times

LCD display

Press **\*** to move the selection, press **#** to enable/disable the selection, After setting, the screen will automatically return to the previous interface.

## 6.9 SmartHome

Press \* for 3 seconds, voice prompting “enter password”.

**\*** + **0** **1** **2** **3** **4** **5** + **#** +   Set the timing to open or close the wireless switch.

Press 9 times

If you want to manually turn the wireless switch on or off, press and hold **\*** for 3 seconds when there is no operation on the panel until the panel voice prompt "Enter password", pls enter the user password **1 2 3 4** to turn on / off the wireless switch.

For example: Set the wireless switch to turn on at 18:35 and turn off at 22:45. (00:00 is invalid time)

Press **\*** for 3 seconds

**\*** → Enter password + **0 1 2 3 4 5** + **#** + **↓** **✓** + **✓**  
Press 9 times

**1 8 3 5** + **\*** + **2 2 4 5** + **✓** → **Settings saved!**  
LCD display

Press **\*** to go to the next column, the screen automatically return to the previous interface after setting.

## 6.10 Time

Press **\*** for 3 seconds, voice prompting "enter password".

**\*** + **0 1 2 3 4 5** + **#** + **↓** **✓**  
Press 10 times

- Auto time
- Daylight-saving time
- 24-hour system
- Time zone
- Time
- Timing Arm/Disarm 1
- Timing Arm/Disarm 2
- Timing Arm/Disarm 3
- Timing Arm/Disarm 4

### 6.10.1 Auto time (default is open)

For example: Set automatic timing to close

Press **\*** for 3 seconds

**\*** → Enter password + **0 1 2 3 4 5** + **#** + **↓** **✓** + **✓**  
Press 10 times

+ **0** + **✓** → **Settings saved!**  
LCD display

0 is disable, 1 is enable. After the setting is completed, the screen will automatically return to the upper interface.

## 6.10.2 Daylight-saving time (The default is to shut down)

Daylight-saving time is set aside by an hour at 2 Am on the first Sunday of middle April. Change 2Am to 3 Am. At 2 o'clock in the morning on the first Sunday in mid-September, The hour will be set aside for one hour, that is, changed from 2 Am to 1Am, and the Daylight-saving time ends. For example: Set Daylight-saving time active.

Press[\*]for 3 seconds

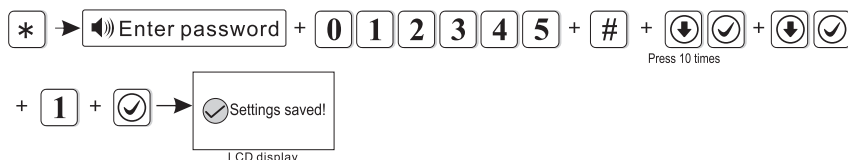

0 is disable, 1 is enable. After the setting is completed, the screen will automatically return to the upper interface.

## 6.10.3 24-hour system (The default is to open)

Example: Set time-zone as London time-zone GMT

Press[\*]for 3 seconds

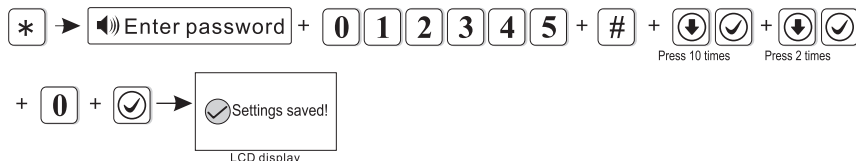

0 is disable, 1 is enable. After the setting is completed, the screen will automatically return to the upper interface.

## 6.10.4 Time zone (default set is Beijing time GMT+8:00)

Example: Set time-zone as London time-zone GMT

Press[\*]for 3 seconds

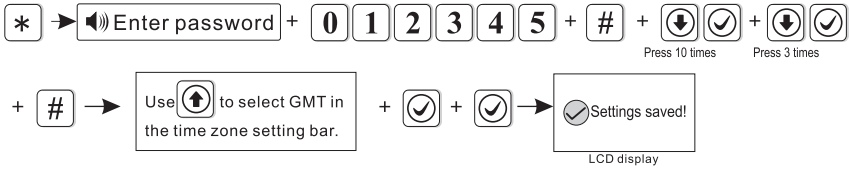

After the setting is completed, the screen will automatically return to the upper interface.

## 6.10. 5 Time

Example Set the time to 15:30 05 on 1 Dec, 2018 .

Press[\*]for 3 seconds

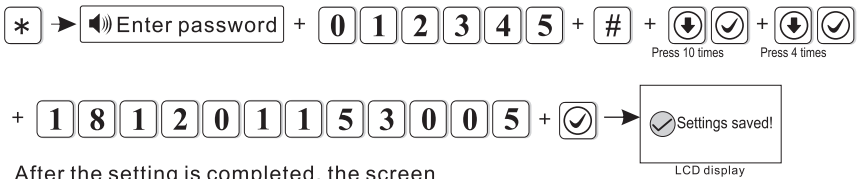

After the setting is completed, the screen will automatically return to the upper interface.

*Note: If you turn on automatic calibration, this setting is invalid*

## 6.10. 6 Timing Arm/Disarm

You can set 4 pairs time for auto timing arm/disarm. Example: set the NO.1 pair as auto arm at 7:58, disarm at 24:03

Press[\*]for 3 seconds

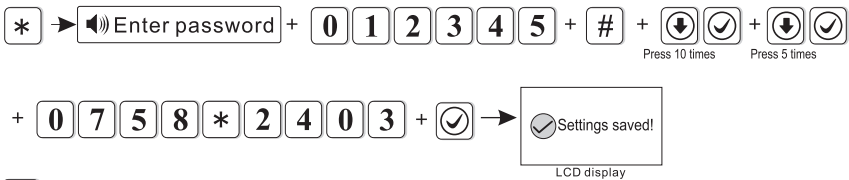

\* For downward selection, After the setting is completed, the screen will automatically return to the upper interface.



## 6.11 Restart

Press \* for 3 seconds, voice prompting “enter password”.

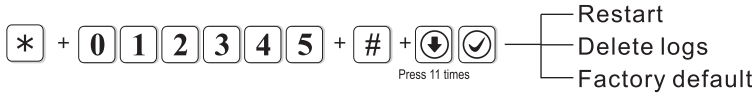

### 6.11.1 Restart

For example: restart the system.

Press[\*]for 3 seconds

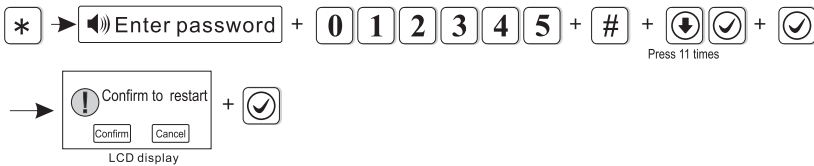

The alarm host will restart after setting.

### 6.11.2 Delete logs

Press[\*]for 3 seconds

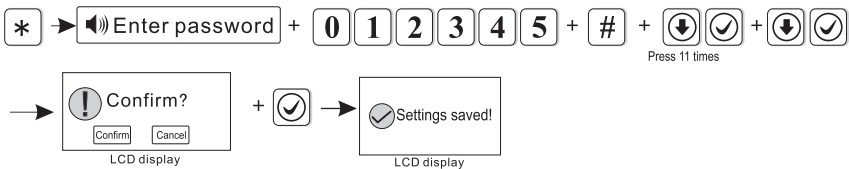

After the setting is completed, the screen will automatically return to the upper interface.

## 6.11. 3 Factory default

Press[\*]for 3 seconds

After the setting is completed, the screen will automatically return to the upper interface.

*Note: After Restore to factory default, the host will clear all the parameter settings, all detectors, remote control, etc. Please Re-code accessories to the alarm panel and re-set other parameters , otherwise it will not work properly.*

## 6.12 Display

— Operating brightness  
 — Standby brightness

Press to Increase the brightness

Press to Reduce the brightness

## 6.13 RFID

Press \* for 3 seconds, voice prompting “enter password”.

to enter RFID setting.

Example: Add the RFID and set it with disarm function.

Press[\*]for 3 seconds



→ Keep the RFID tag near the sensor area



Options:

- Disarm
- Home
- Disarm SMS
- Home SMS
- Disarm-call phone 1



After the setting is completed, the screen will automatically return to the upper interface.

*Note: 1. Pls preset the message text on WEB MENU for the two options [disarm and send sms ][ home arm and send sms]*

*2. You can choose to manual enter the RFID card # to add the RFID card.*

## 6.14 Others

Press \* for 3 seconds, voice prompting “enter password”.



### 6.14.1 Recording

20seconds time to record alarm message. This alarm message will be hear when you take the alarm phone call from the alarm panel.

Press[\*]for 3 seconds



+ [#] → Start record after hear beep sound. The alarm message will play once after finish recording.

## 6.14.2 Play

Press[\*]for 3 seconds

\* → Enter password + 0 1 2 3 4 5 + # +   +  

Press 14 times

+ # → play the alarm message

## 6.14.3 PGM





the voltage will change from 0V to 12V as soon as some events occurs.  
(Default is follow alarm output)

Trigger events can be set as below

- |                                      |                                 |
|--------------------------------------|---------------------------------|
| 1. Follow alarm output               | 2. Follow AC power fault output |
| 3. Follow arm output                 | 4. Follow disarm output         |
| 5. Follow communication fault output | 6. Password control output      |



Example : set PGM output follow AC power fault output.

Press[\*]for 3 seconds

\* → Enter password + 0 1 2 3 4 5 + # +   +  

Press 14 times

Press 2 times

+ # + \* +  →  Settings saved!

LCD display

Hint: when setting as password control output, press key 5 for 3 seconds, then enter the user password, the programme output port will be open or closed. Voice phone or SMS also can open or close the outport.

## 6.14.4 Chime Music

Two tones optional : "ringing tone" and "Welcome". (Default welcome)  
For example: set the door open tone as "ringing tone"

Press[\*]for 3 seconds

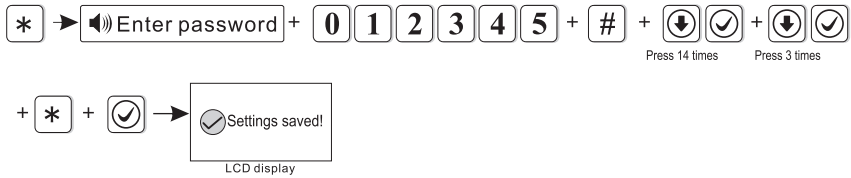

After the setting is completed, the screen will automatically return to the upper interface.

## 6.15 Corss zone

Press \* for 3 seconds, voice prompting “enter password”.



Trigger zone 1 or zone 2 only will not trigger alarm. During related time trigger zone 1 and zone 2, then the alarm will be trigger.

Example: Set zone 5 and zone 9 as pair # 4 related zone, related time is 120secs.

Press[\*]for 3 seconds

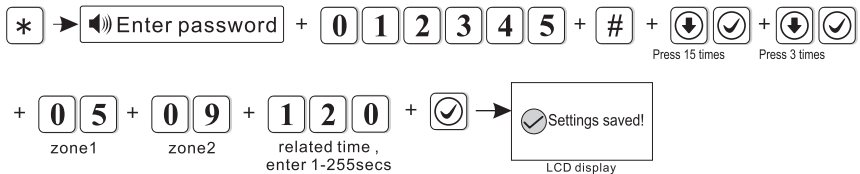

After the setting is completed, the screen will automatically return to the upper interface.

**NOTE:** Can set 8 pairs related zone.

## 6.16 About

Press \* for 3 seconds, voice prompting “enter password”.



## Chapter VII Web IE introduction

Enter the system setting—click the icon  enter “IP” to check the IP of the alarm panel(see page 16).

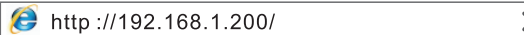
Open the IE browser and enter the IP of the panel, click enter to confirm. For example: 

pls enter the USER **【admin】** , PW **【012345】** are factory default.

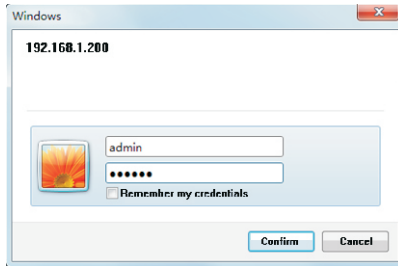

Open the internet browse as below photo.

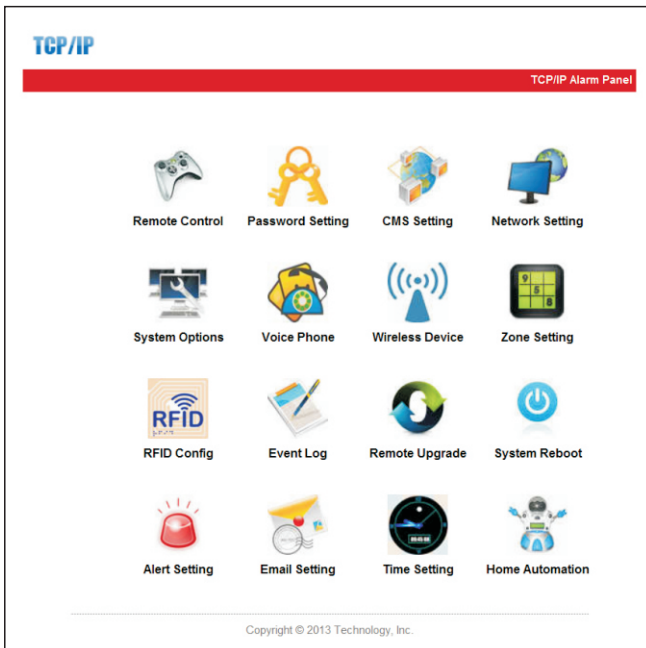

## 7.1 Remote Control

Press the remote control icon  to enter below interface.

**7.1.1 System status:** In the control status bar select:pls choose system arm, system stay, system disarm, cancel alarm.

### Remote Control

**prompt :** Achieve network remote control

---

System status

**System arm/disarm:** system disarm ▾

system arm

system stay

system disarm

cancel alarm

---

Zone bypass

**zone:** ▾ **bypass:** ▾

**7.1.2 Zone bypass:** In the Zone Bypass Bar, pls Select the zone # and bypass Enable , disable(the default system number 01-40 a total of 40 zones).

After choosing the type of bypass, the system prompts as the right figure, Press confirm to complete the zone bypass setting.

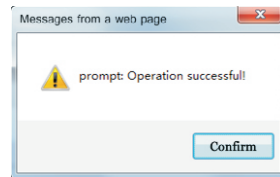

**7.1.3 System status:** after finish zone bypass setting, you can check the system status at system status bar.

Zone bypass

**zone:** 28 ▾ **bypass:** Enable ▾

---

System status

NO.	ZONE/SYSTEM	STATUS
1	28	zone bypass

**7.2 Password setting:** Click on the icon  to enter WEB administrator password settings, WEB user password Settings, 1-16 host user password settings.

**prompt :** Change the login username and password ,Only WEB admin and WEB user password can login web pages,User password just can operate from the panel.

WEB Admin

**WEB login username:**

**WEB login password :**

WEB user

**WEB login username:**

**WEB login password :**

Panel user

**User password No.:**

**User password:**

Save

WEB User account can arm/disarm , voice phone setting.  
But can not manage the web and alarm panel.

After the user name and password are entered, Click save, the system prompts "set data Saved ", click "confirm "to complete the password Word setting.

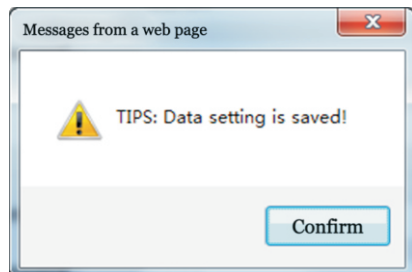



**7.3 CMS center setting:** click icon  to enter voice phone CMS and network CMS.

### 7.3.1 Voice phone CMS setting

Select to enable the voice phone alarm CMS: Choose enable the voice phone alarm CMS.

Fulfill the CMS setting, click "Save Settings" to complete the telephone alarm platform settings.

CMS Phone	
<input checked="" type="checkbox"/> Enable CMS Phone	
CMS Phone No. 1:	<input type="text"/>
CMS Phone No. 2:	<input type="text"/>
User ID No.:	<input type="text" value="0000"/>
Dialing times (1-15):	<input type="text" value="5"/>

### 7.3.2 Network CMS setting

Select to enable the network alarm CMS: Select “  ” to enable the network alarm CMS.

Fulfill the CMS setting, click "Save Settings" to complete the network alarm platform settings. Then restart the alarm panel to active the setting.

Network CMS	
<input type="checkbox"/> Enable Network CMS	
Server Address:	<input type="text" value="0.0.0.0"/>
Server Port:	<input type="text" value="7974"/>
ID account:	<input type="text"/>
Password:	<input type="text"/>
Heartbeat times(1-255s):	<input type="text" value="180"/>

*Note: The alarm panel can connect to one of the CMS only. from voice phone CMS and network CMS. If you enable both two CMS, the system Will connect to the network CMS priority.And transfer to connect to voice phone CMS when the network CMS is with problem.*

## 7.4 Network configuration: click icon for setting.

**prompt** :Configure the related network parameters,need to restart the panel.

Network Configuration	
MAC Address:	<input type="text" value="00:00:5E:38:50:8E"/>
Panel name:	<input type="text" value="TCPIP_PANEL"/>
IP Address:	<input type="text" value="192.168.1.200"/>
Default gateway:	<input type="text" value="192.168.1.1"/>
Subnet mask:	<input type="text" value="255.255.255.0"/>
Preferred DNS:	<input type="text" value="202.96.128.86"/>
Standby DNS:	<input type="text" value="8.8.8.8"/>
Web Port (DEF 80):	<input type="text" value="80"/>

**7.4.1** The factory default setting if IP is DHCP, If you want to set the IP, pls disable the DHCP function first. Pls set the IP according to the local IP setting, can not use the same IP for several alarm panels.

**7.4.2** When set IP、gateway、CMS, need 3-digit, if less than 3-digit, use "0" for replacement eg, if your IP is “192.168.1.81” you need enter number like “192.168.001.081”。

**7.4.3** Press save key after complete settings and exit menu.Then reboot alarm panel to take effect

## 7.5 System Options: click icon to system options settings

System Options	
Entry delay(0-255S):	<input type="text" value="10"/>
Exit delay(0-255S):	<input type="text" value="10"/>
Siren time(0-30M):	<input type="text" value="5"/>
Wireless detector loss(H):	<input type="text" value="0"/>
AC off inspection time(M):	<input type="text" value="30"/>
Communication test(H):	<input type="text" value="0"/>
Arm/disarm tone:	<input type="text" value="no voice"/>
Arm/disarm report:	<input type="text" value="Enable"/>
Force arm:	<input type="text" value="Disable"/>
Door contact inspection:	<input type="text" value="Disable"/>
Wireless detector tamper:	<input type="text" value="Enable"/>
Zone alarm times:	<input type="text" value="no limited"/>

- 1.Entry delay is only for delay zones.
- 2.Exit delay time: User need exit within preset time after system armed.
- 3.Siren time: The alarm duration time after system alarm, default value: 5 minutes
4. Wireless detector loss time: If the panel doesn't receive status signal or alarm signal within preset time, the panel will regard the detectors as loss.
5. AC off inspection time: When system AC power cut, user can set the delay time to report to CMS, default value : 30minutes
6. Communicate test time: The interval test time between system and CMS, default value: Disable
- 7.Arm/Disarm tone: user can enable/disable arm/disarm tone when arm/disarm system via remote controller.
- 8.Arm/Disarm report: User can enable/disable Arm/Disarm report to CMS, default value is :disable.
- 9.Force arm: When enable force arm , System still can be force armed when zones are in trouble and trouble zones will be bypassed automatically and system will send bypass information to CMS. When disable force arm, system can not be armed when zones are in trouble. Default value: Disable
10. Door contact inspection: When door/window is not well closed, the system will receive zone trouble information from door contact if enable door contact inpection. Default value: Disable.
- 11.Wireless detector tamper: default value: enable
- 12.Zone alarm time:If system is triggered more than once before system disarm or cancel alarm, the system will not alarm if user set zone alarm time as 1.

## 7.6 Voice Phone

Press the icon  to set the voice phone and mobile App control setting.

**7.6.1 Voice phone setting:** users can set 4 voice phone No. Dialing times default setting is 5.

Voice Phone

voice phone 1:	<input type="text"/>
voice phone 2:	<input type="text"/>
voice phone 3:	<input type="text"/>
voice phone 4:	<input type="text"/>
Redial attempts(1-15):	<input type="text" value="5"/>

### 7.6.2 Mobile App Remote Control Setting (Remote Control Server)

Server IP: Offered by the operator

Server Port: default 18034

Account: Automatically enrolled by the device

Password: Default 12345678

Users can scan the QR code to enroll the device account for mobile APP control.

Remote Control Server

Server IP:	<input type="text" value="47.91.74.102"/>
Server Port:	<input type="text" value="18034"/>
User:	<input type="text" value="8E50355E"/>
Password:	<input type="text" value="12345678"/>

APP scan QR code register



## 7.7 Wireless Device

It can set 8 remotes 32 detectors, 16CH smart light switch.

**prompt** : enroll and delete the devices operation, clear the data refer to delete device.admin authority operation.

Wireless Devices

remote controller No.:	<input type="text"/>
remote controller ID:	<input type="text"/>
detector No.:	<input type="text"/>
detector ID:	<input type="text"/>
appliance switch No.:	<input type="text"/>
appliance switch ID:	<input type="text"/>

## 7.8 Zone Setting

Press icon  enter into zone setting.

**prompt**: setup the system zone attributions and related zone. admin authority operation.

Zone Name: to give a name to the zone, when the host send emails and SMS, it will be sent zone name instead of zone No..

Related Zone: only trigger one of a group of related zone won't alarm, In a set of related time, it has triggered a set of related zone of two successively, it can lead to alarm. setup the related time 0 refer to the related zone disable.

Zone Attribution

zone No.:	<input type="text"/>
attributions:	<input type="text" value="Disable"/>
siren type:	<input type="text" value="pedal point"/>
zone name:	<input type="text"/>

## 7.8.1 Zone1-Zone 40 zone attributions

0>disabled zone      1>delay zone      2>perimeter zone  
3>interior zone      4>panic zone      5>24H zone  
6>fire zone      7>key zone

## 7.8.2 Siren type

1. pedal      2. pulse      3. mute

## 7.8.3 It can set 8 groups of zone group linkage.

Related Zone

**related zone group:**

**related zone 1:**

**related zone 2:**

**related time(0-255s):**

*Note: Key zone only can be setting for the wired zone 33-40.*

## 7.9 RFID Setting

It can set the RFID's enroll, delete, and functions from 01-16 tags.

1. disabled      2. Disarm      3. Disarm then stay arm  
4 Disarm and send SMS      5. Stay arm and send SMS  
6, Disarm and call voice phone number 1

*Note: If user choose the RFID tag function as disarm and send SMS.*

*The user can input the message as RFID SMS text box. It can support 60 characters.*

**prompt :** RFID parameter , if select RFID sending SMS please enter SMS text in below textbox.  
Max. 60 characters.

RFID device

**RFID tag serial number:**

**RFID tag code:**

**RFID tag function:**

**RFID SMS text:**

## 7.10 Event Log: click icon to enter.

prompt:The latest 512 Event Logs .

No.	Time	Zone / User	Event log
1	2015-05-16 15:21:03	40	Zone Bypass
2	2015-05-16 15:20:42	40	Zone Bypass
3	2015-05-16 15:19:53	28	Zone Bypass
4	2015-05-16 14:35:21	0	Periodic Test Report
5	2015-05-16 12:35:16	0	Periodic Test Report
6	2015-05-16 09:40:55	0	Periodic Test Report
7	2015-05-16 07:40:42	0	Periodic Test Report
8	2015-05-16 05:40:28	0	Periodic Test Report
9	2015-05-16 03:40:15	0	Periodic Test Report
10	2015-05-16 01:40:07	0	Periodic Test Report
11	2015-05-15 23:40:02	0	Periodic Test Report
12	2015-05-15 21:39:57	0	Periodic Test Report
13	2015-05-15 19:45:39	70	System Stay
14	2015-05-15 19:39:52	0	Periodic Test Report
15	2015-05-15 18:26:52	70	System Disarm
16	2015-05-15 18:26:43	70	System Stay
17	2015-05-15 18:26:36	1	Zone Bypass
18	2015-05-15 18:26:23	70	System Disarm
19	2015-05-15 18:26:14	70	System Stay
20	2015-05-15 17:42:02	40	Alarm Cancel
21	2015-05-15 17:41:58	0	Tamper
22	2015-05-15 17:41:33	1	System Disarm
23	2015-05-15 17:41:33	1	Alarm Cancel
24	2015-05-15 17:41:23	0	Tamper

Next

Previous

*It can inquiry the latest 512 event log. If user want to delete the event log, please browse manual page 41 to delete system log.*

## 7.11 Remote upgrade: click icon to enter setting.

**Warning:** Error of the upgrade file will bring disastrous consequences to your device, please be careful operation! If there is a upgrade error please contact us. The upgrade file is divided into application and webpage file. An upgraded operation need all or part of the files. Please contact your distributors for further details. If you need to upgrade webpage and application at the same time, please upgrade the webpage in advance.

Admin Authority Operation

Webpage Ver.: V0.01F

Hardware Ver.: V0.03F Aug 23 2015

Software Ver.: V1.51F\_SIA\_TCP Nov 21 2017 11:08:25

Webpage

webpage:

browsing

submit

Application

application:

browsing

submit

**Note:** Press the browse and pops up window to load the file then submit for upgrading.  
*in the process of the upgrading, it will show the percentage of the process. please do not close the web page and power off the computer. After upgrading success, please restart the alarm control panel.web upgrading file name as Bin, alarm software for device as hex.*



## 7.12 System Reboot

Press icon  to set the system reboot, restore to factory and backup.

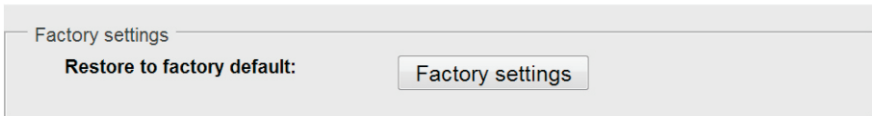
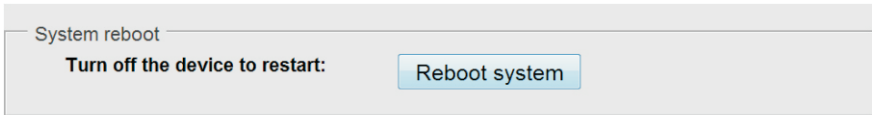

**7.12.1 system reboot:** click up the system reboot pops up window and let users confirm reboot setting. Press confirm, the system will reboot. Otherwise, click cancel.

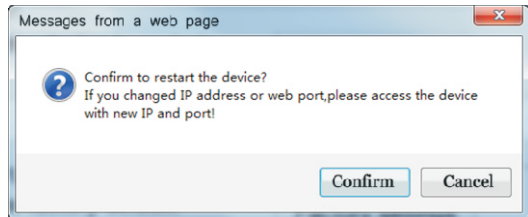

### 7.12.2 Factory settings:

click up restore to factory that pops up window prompt please input the admin password, after input the correct password, the system will restore to factory setting.

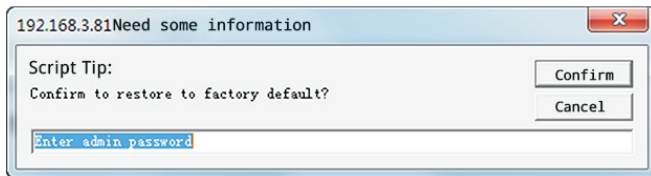

**7.12.3 Configuration file backup:** If users want to make more panels with same settings, users can export the current software version then import to new devices. Click up the export configuration pops up download command, press "save".

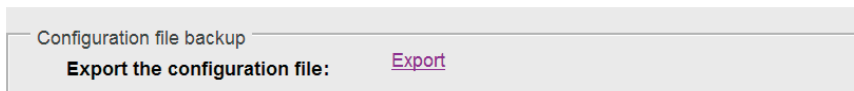

**7.12.4 Profile Import :** Click up the browse pops up the upload window, choose “ config.bin” and open it . closed the window automatically and import the bin file and click up submit.

Profile import

**Import config file:**

## 7.13 Alert Setting

Press icon  can set 28 methods of alarm sending ways and GPRS parameters configuration.

**System Alert:** choose the alarm types that you need and ticked out the sending ways then saved.

Alert Setting

**System Alert:**

**Methods of sending:**  CMS  Voice Phone  SMS  Email

GPRS Parameter Configuration

**GPRS APN :**

**GPRS USER :**

**GPRS PASSWORD :**

## 7.14 Email Setting: Press icon to set the email.

1. SMTP server: input the senders SMTP server address.  
Make example smtp.163.com
2. SMTP default port : 25( do not support SSL Encrypted port)
3. Send email needs to login email setting, and enable the SMTP functions.

**prompt:** The system sends a message to the specified mailbox after the alarm, if you want to send mail to more recipients, please enter multiple e-mail address in the recipient addresses separated by commas.

Email Setting

<b>SMTP Server:</b>	<input type="text"/>
<b>SMTP port:</b>	<input type="text" value="25"/>
<b>Email User Name :</b>	<input type="text"/>
<b>Email Login Password :</b>	<input type="password"/>
<b>Sender :</b>	<input type="text"/>
<b>Recipients:</b>	<input type="text"/>

Save

## 7.15 Time Setting

Press icon  to set the system time and timing arm/disarm configuration.

**1. Server Time:** China national center for time: 210.72.145.44.

US Standard for time: time.nist.gov.

**2. Timing Arm/Disarm:** Support 4 Groups, the host device can be auto arm/disarm the system within the defined time.

**3. Please choose the correct time zone before setting time.**

**Reminder:** Set correct server time and local time zone, obtain network time and automatic calibration every 24 hours.

Time setting

Automatic Calibration

Server Time :

Time Zone (GMT) :

Update:











Timing Arm/disarm

Timing Arm Time 1 :	<input type="text" value="00:00"/>
Timing Disarm Time 1 :	<input type="text" value="00:00"/>
Timing Arm Time 2 :	<input type="text" value="00:00"/>
Timing Disarm Time 2 :	<input type="text" value="00:00"/>
Timing Arm Time 3 :	<input type="text" value="00:00"/>
Timing Disarm Time 3 :	<input type="text" value="00:00"/>
Timing Arm Time 4 :	<input type="text" value="00:00"/>
Timing Disarm Time 4 :	<input type="text" value="00:00"/>

## 7.16 Home Automation: Press the icon and set the home automation.

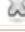
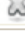
### Home Automation

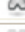
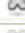
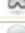
**prompt:** This is to set remote control, switch location and timing on/off of the switch enrolled to the alarm panel. click "save" button to set and control switch. The real-time switch status maybe different from status you see on this page. click "save" click button to synchronize switch status.

NO.	swtich location	status	ON/OFF	timing on	timing off	submit
1.	1234567890		<input type="button" value="v"/>	<input type="text" value="00:00"/>	<input type="text" value="00:00"/>	<input type="button" value="save"/>
2.	3563233222		<input type="button" value="v"/>	<input type="text" value="00:00"/>	<input type="text" value="00:00"/>	<input type="button" value="save"/>
3.			<input type="button" value="v"/>	<input type="text" value="00:00"/>	<input type="text" value="00:00"/>	<input type="button" value="save"/>
4.			<input type="button" value="v"/>	<input type="text" value="00:00"/>	<input type="text" value="00:00"/>	<input type="button" value="save"/>
5.			<input type="button" value="v"/>	<input type="text" value="00:00"/>	<input type="text" value="00:00"/>	<input type="button" value="save"/>
6.			<input type="button" value="v"/>	<input type="text" value="00:00"/>	<input type="text" value="00:00"/>	<input type="button" value="save"/>
7.	1111111111		<input type="button" value="v"/>	<input type="text" value="00:00"/>	<input type="text" value="00:00"/>	<input type="button" value="save"/>
8.	1111111111		<input type="button" value="v"/>	<input type="text" value="00:00"/>	<input type="text" value="00:00"/>	<input type="button" value="save"/>
9.			<input type="button" value="v"/>	<input type="text" value="00:00"/>	<input type="text" value="00:00"/>	<input type="button" value="save"/>
10.			<input type="button" value="v"/>	<input type="text" value="00:00"/>	<input type="text" value="00:00"/>	<input type="button" value="save"/>
11.			<input type="button" value="v"/>	<input type="text" value="00:00"/>	<input type="text" value="00:00"/>	<input type="button" value="save"/>
12.			<input type="button" value="v"/>	<input type="text" value="00:00"/>	<input type="text" value="00:00"/>	<input type="button" value="save"/>
13.			<input type="button" value="v"/>	<input type="text" value="00:00"/>	<input type="text" value="00:00"/>	<input type="button" value="save"/>
14.			<input type="button" value="v"/>	<input type="text" value="00:00"/>	<input type="text" value="00:00"/>	<input type="button" value="save"/>
15.			<input type="button" value="v"/>	<input type="text" value="00:00"/>	<input type="text" value="00:00"/>	<input type="button" value="save"/>
16.	2222222222		<input type="button" value="v"/>	<input type="text" value="00:00"/>	<input type="text" value="00:00"/>	<input type="button" value="save"/>

1. Please enroll the smart light switch from the panel or webIE configuration
2. Users can name the smart light switch and set the timing on/off periods.  
Max support 16CH light switch.

## Chapter VIII APP User Manual

The user can scan the QR Code (see page 21) to download the APP. The following specific operation instructions take the Android system as an example. iPhone system, please refer to this.

### 8.1 Create account

Please follow the steps below:

- A. Press  and hold the panel for more than 3 seconds, the voice prompt "Please enter the password", then input 1234 # to enter the user settings and select "APP QR Code";
- B. Click "Account" - "Add" - "Sweep to add an account" - "Scan QR Code of panel"; (as shown in Figure 8-1, Figure 8-2, Figure 8-3, Figure 8-4 )

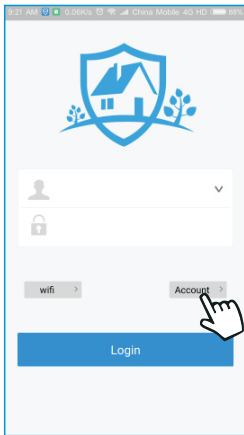

Figure 8-1

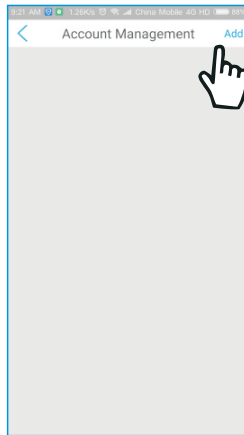

Figure 8-2

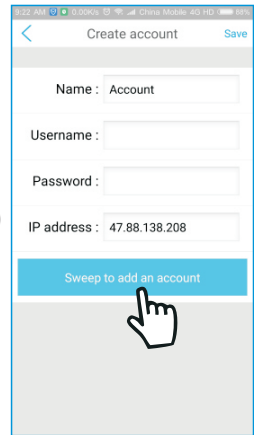

Figure 8-3

- C. After scanning the QR Code successfully, the "Create Account" interface appears, as shown in Figure 8-5

**Name:** User can set by yourself

**Username:** Device ID number(no need to change)

**Password:** The default is 12345678( The user can change PWD on the panel (see page 23) or the web page (see page 52)

**IP address:** 47.91.74.102

After finishing enter, please click Save.

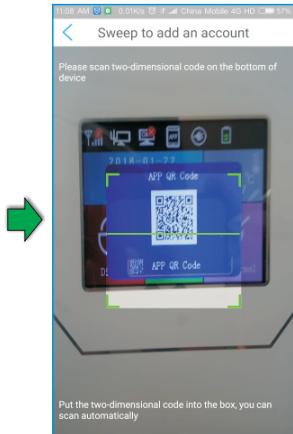

Figure 8-4

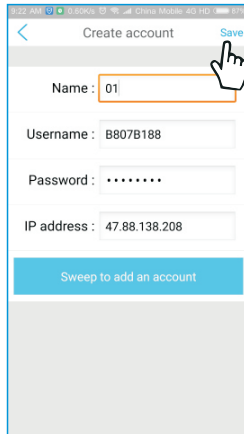

Figure 8-5

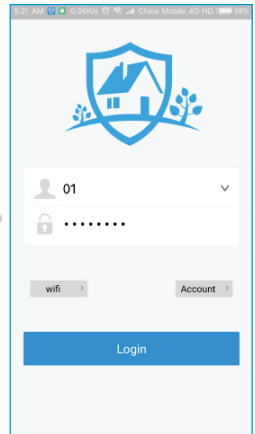

Figure 8-6

D. After save, return to login interface, then display the registered account. (Figure 8-6)

Log in to enter the setup interface as shown in Figure 8-7, Figure 8-8, Figure 8-9 below:

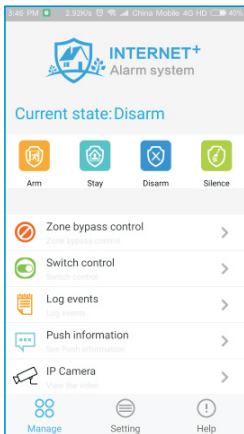

Figure 8-7

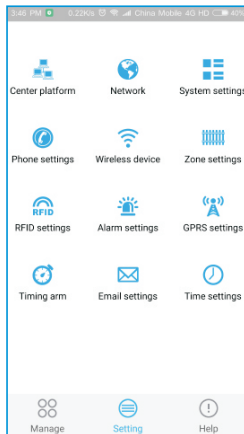

Figure 8-8

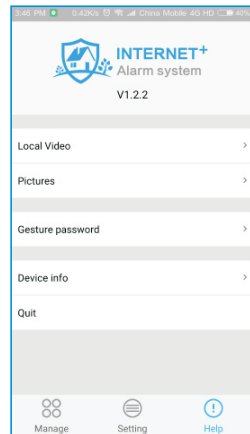

Figure 8-9

## 8.2 Modify the CMS account password

Enter "Center platform" – "Network relay platform" – "Password" to revise the password (as shown in Figure 8-10).

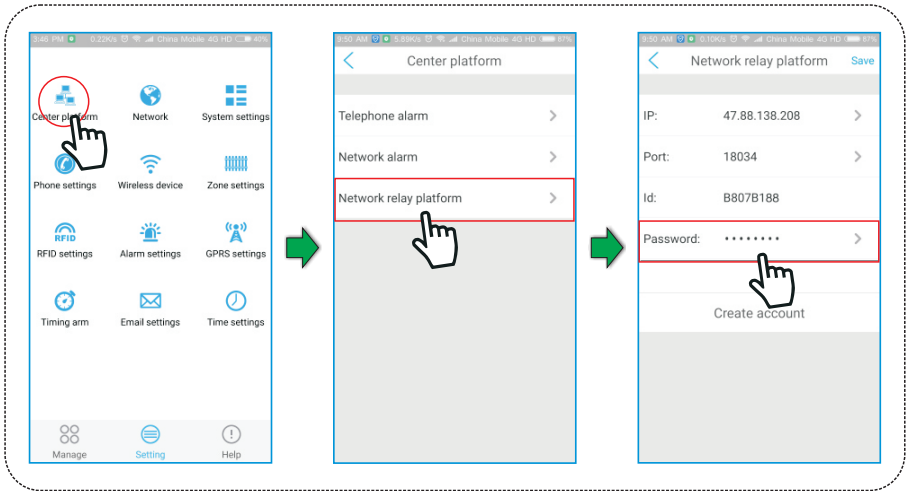

Figure 8-10

## 8.3 Add Cameras

As shown in Figure 8-11, Figure 8-12, Figure 8-13, please enter the camera add interface. You can manually input the device information, search device and scan code adding device to add the camera by these three ways:

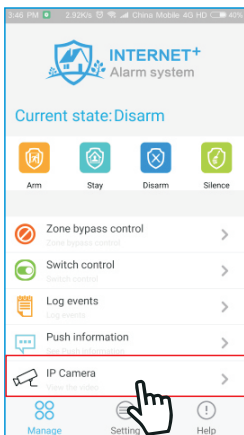

Figure 8-11

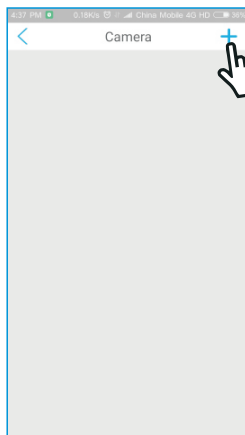

Figure 8-12

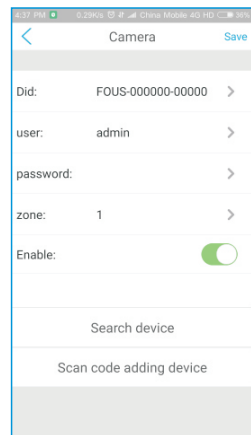

Figure 8-13



**Input manually:** Click the input field to enter the input interface, then click Save;  
**Search device:** Click the search device to enter the automatic search interface.  
And the camera must be plugged into a power supply and network.  
**Scan code adding device :** Please scan the QR Code on the bottom of camera (maximum add 8 cameras), as shown in Figure 8-14 and Figure 8-15.



Figure 8-14



Figure 8-15

## Chapter IX Technical Specification

### General information

**Power supply:** 12V/1.5A

**Built in rechargeable battery:**7.4V/ 2000mAh

**Low battery voltage:** 6.6V

**Low voltage shutdown:** 6.0V

**Charging voltage:** 8.4V

**Disabled working voltage:** 8. 7V

**System static current:** <50mA(exclude wired detector)

**System alarming current:** <300mA(exclude wired high siren current)

**System maximum output current:** ≤100mA(supply wired detector)

**Modulation:**ASK

**Frequency:**433MHz/868MHz(Optional)

**Signal transmit distance:** 100 to 150 meters (open area)

**The method of alarming dial:** Internet IP, GSM or GPRS

**Communication protocol with CMS:** Ademco Contact ID

**DTMF dial frequency variation:**<1.5%

**Recording time:**20s

### Physical performance.

**Operation temperature range:** 0°C-45°C(32°F-120°F)

**Storage temperature range:** -20°C-60°C(-4°F-140°F)

**Relative humidity:** 85% at 30°C(86°F)

**Color:** See real

## Chapter X Maintenance

### 10.1 Regular Test

Design of components of the system is to reduce maintenance cost, but still it is suggested that periodical check may be carried out.

### 10.2 The Cleanliness of Control Main Machine

Main control panel may be stained by fingers or covered by dust after using for a while. Use soft cotton cloth or sponge to clean it, don't use any lubricant, liquid such as kerosene, acetone and strong gel which will damage appearance and the transparency of top window.

Attention: don't use any lubricant, liquid such as kerosene, acetone and strong gel which will damage appearance and the top transparency of window.

## Chapter XI Limitation of the Products

Although the products is a high standard products, there is also some limitation of them such as false alarm or no alarm. The reasons may be below:

Lack of maintenance, the system needs maintenance and test regularly test the sensitive of the detector may decrease and the siren may not whistle.

Lack of power supply if no power input and the back up power is not enough, the panel can not work normally.

Limitation of smoke detectors, if the smoke is far from the smoke detector, the detector could not alarm.

If the intrude break in through some door or window not monitored. Or someone know how to make the system not work.



